

## Android Indoor Station Firmware Release Note

### V2.1.74\_build221110 (2022-11-21)

#### 1. Firmware Basic Information

Firmware Basic Information	Firmware Version	V2.1.74_build221110
	Device Model	DS-KH9310-WTE1(B) DS-KH9510-WTE1(B)

#### Notes:

Please update firmware to the latest version to ensure the better user experience

#### New Feature:

1. Indoor extension also supports internal Hik-Connect App.

Note:

- A. currently the HC login status can not be synchronized from indoor station to extension, you have to login manually on extension device.
- B. Internal Hik-Connect is a special version and will not display intercom devices in the list

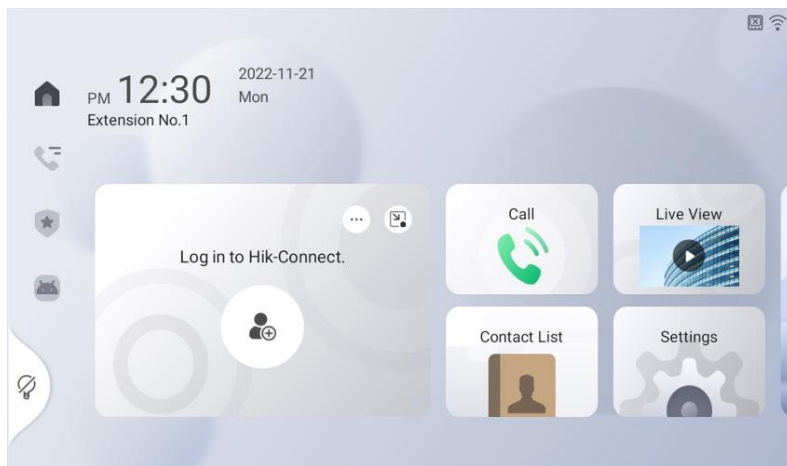

2. Add new function in wizard to check whether the activation password of the door and indoor station are the same, if not, it will prompt to enter the door station password in a separate pop-up box.

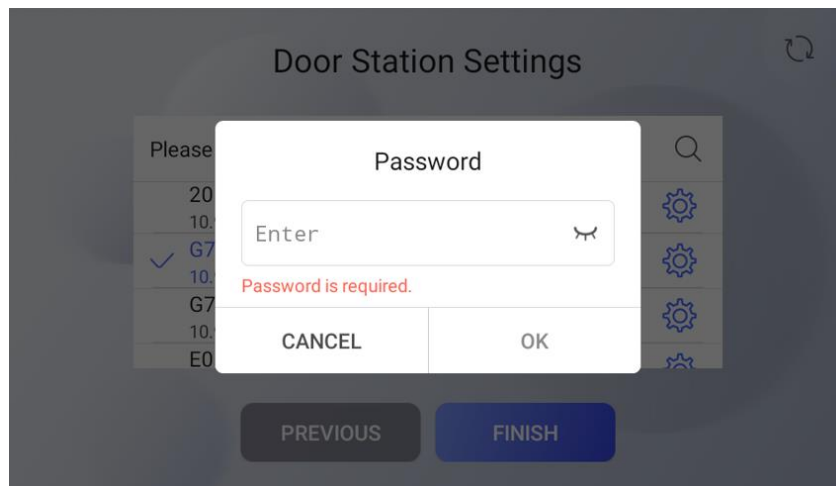

## Modified Feature:

1. Change the gradient background at the top of the preview screen to transparent

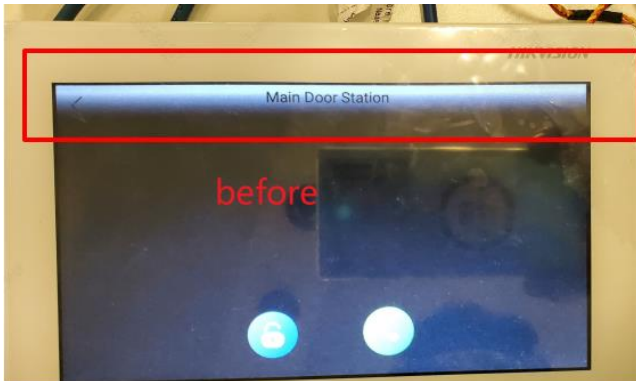

## Android Indoor Station Version: V2.1.48\_build220620 Release Note (2022-08-02)

### 2. Firmware Basic Information

<b>Firmware</b>	Firmware Version	V2.1.48_build220620
	<b>Basic Information</b>	Device Type

#### Notes:

Please update firmware to the latest version to ensure the perfect user experience

#### New:

3. Adds the function of sending captured images to Hik-Connect. When receiving a call from door station, the door station will capture an image and the image will be sent to Hik-Connect.

## Fix:

1. Extends the limited third-party resource. (Memory 500 M CPU 30% flush 1G)
2. Displays custom device name on the live view list and the corresponding live view website page.

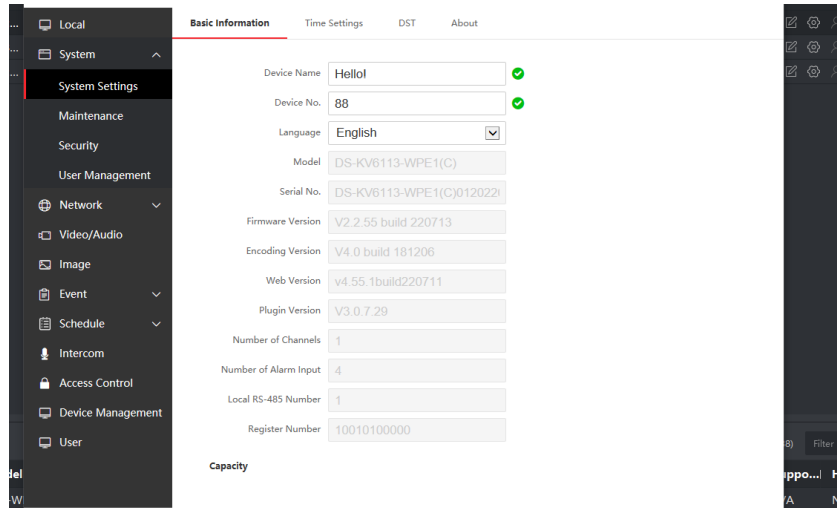

Live View

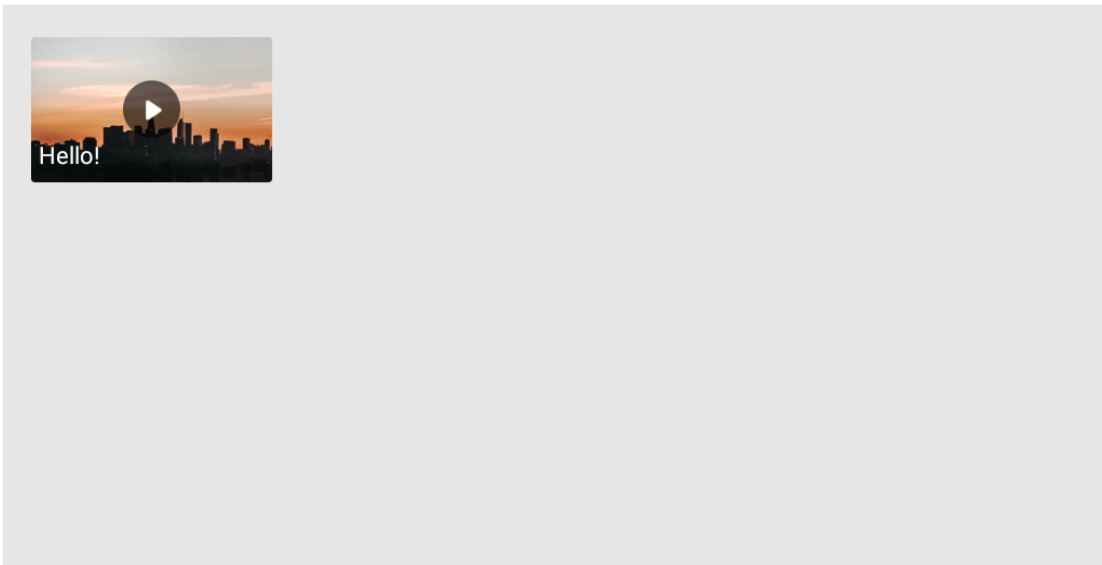

3. Deletes the installation package automatically when the APK file is installed.

**Android Indoor Station**  
**Version: V2.1.30\_build220402**  
**Release Note**  
**(2022-04-02)**

### 3. Firmware Basic Information

<b>Firmware</b>	Firmware Version	V2.1.30_build220402
<b>Basic Information</b>	Device Type	DS-KH9310-WTE1(B) DS-KH9510-WTE1(B)

#### Notes:

Please update firmware to the latest version to ensure the perfect user experience

#### 3.1 Recommended Firmware

It is recommended to use the following devices and version together, because they can cooperate and work normally after the docking test.

Test resource	Device type	Version
Door Station	KD9403	V2.2.37_210929
	KD8003	V2.2.52_211126
	KV6113	V2.2.53_211104
	KB8113	V2.2.51_211110
<b>Indoor Station</b>	<b>DS-KH9310</b>	<b>V2.1.30_build20220402</b>
Main Station	KM9503	V1.0.32_build210926

#### Notes:

Test records only contain the cases for normally devices and do not represent all the scenarios and all the functions.

#### 3.2 Compatibility

(1) This firmware version is use to update below models:

- DS-KH9310-WTE1(B)
- DS-KH9510-WTE1(B)

And this firmware CAN'T be updated to below models:

- DS-KH9310-WTE1
- DS-KH9510-WTE1

(2) For master-extension connections, below models with latest FW are recommended:

- DS-KH9310-WTE1/(B)
- DS-KH9510-WTE1/(B)
- DS-KH8350-WTE1/TE1
- DS-KH8520-WTE1
- DS-KH6320-WTE2/(B)
- DS-KH6320-LE1(B)

Following devices with Protocol 1.0 are not compatible with above models.

- DS-KH6320-LE1
- DS-KH6220-LE1

## 4. V2.1.30\_build220402 Upgrade Note

### 4.1 Added Function:

#### 1) Support reset admin password via email or security questions.

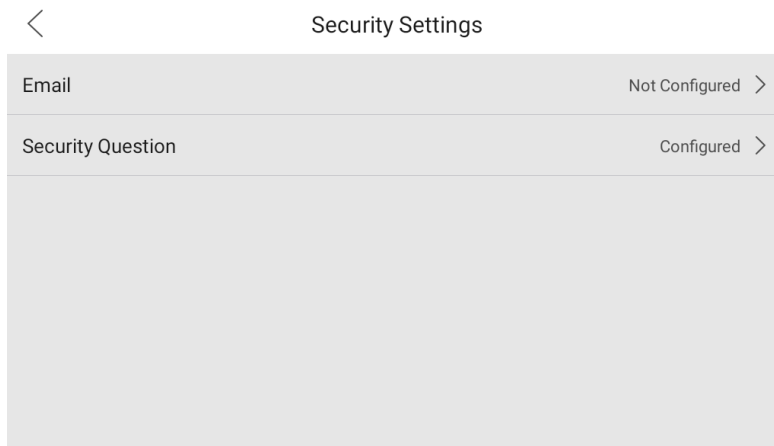

#### 2) Support unlock via gesture.

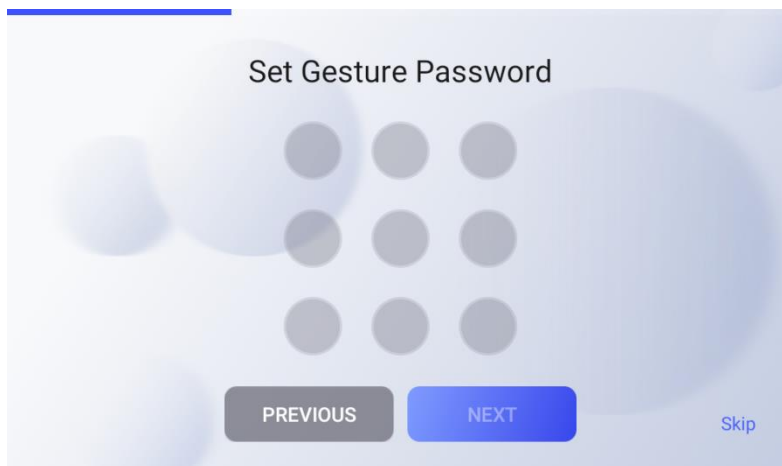

#### 3) Support captured image, message auto-deletion function.

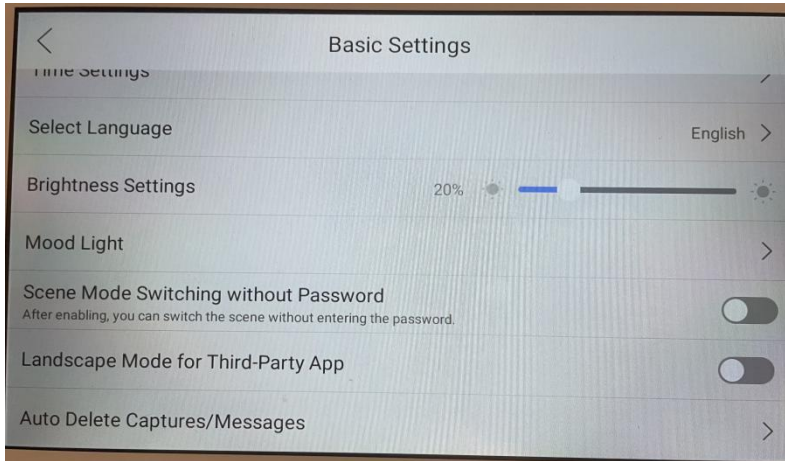

#### 4) Support switch to the IPC live view page during 2-way audio.

## 4.2 Feature Optimization:

### 1) Support unicast and multicast options for video stream.

For multicast mode, the new version is supported up to 15 channels of video stream, but the switch or router must support the multicast mode at the same time, otherwise it can only support 6 channels of video stream.

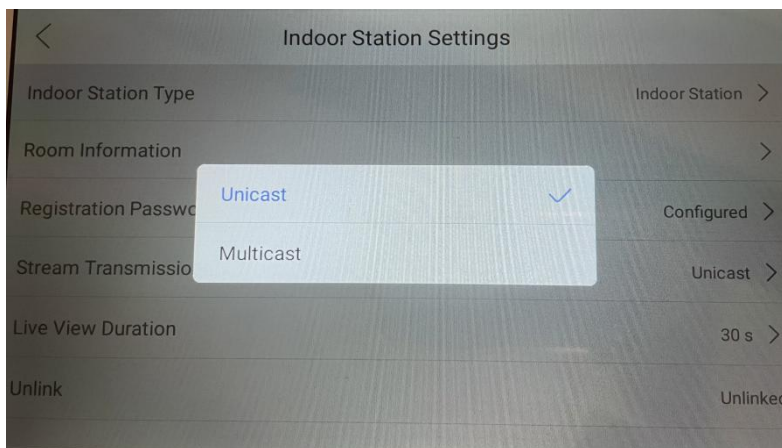

### 2) 22 languages are supported

English, French, Portuguese (Brazil), Spanish, Russian, German, Italian, Polish, Arabic, Turkish, Vietnamese, Hungarian, Dutch, Romanian, Czech, Bulgarian, Ukrainian, Croatian, Serbian, Greek, Norwegian, Danish

### 3) UI new style and optimization

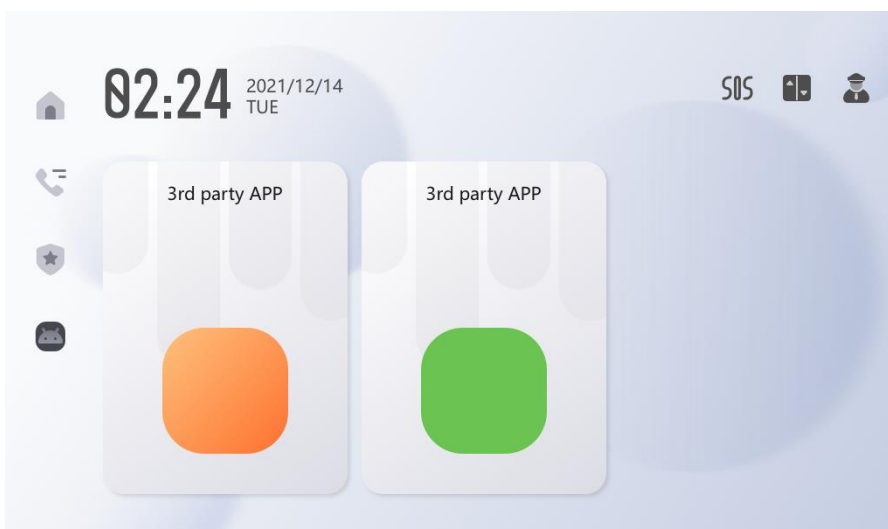
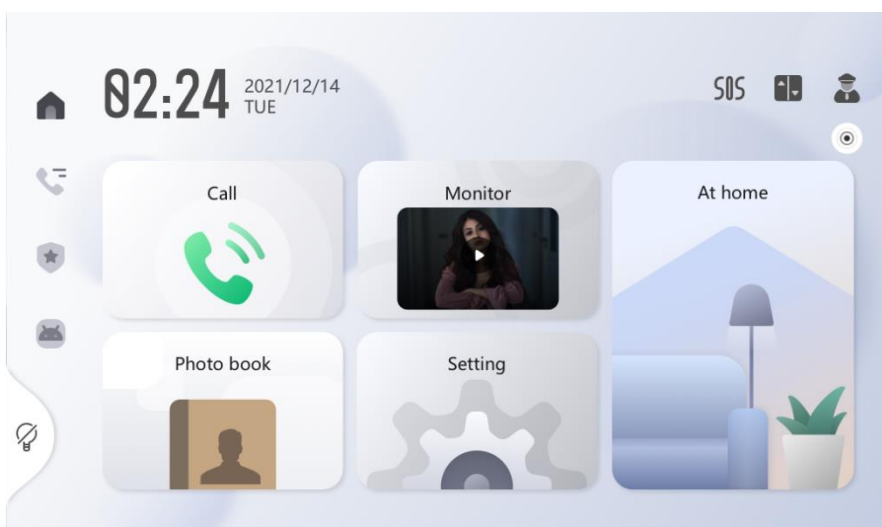
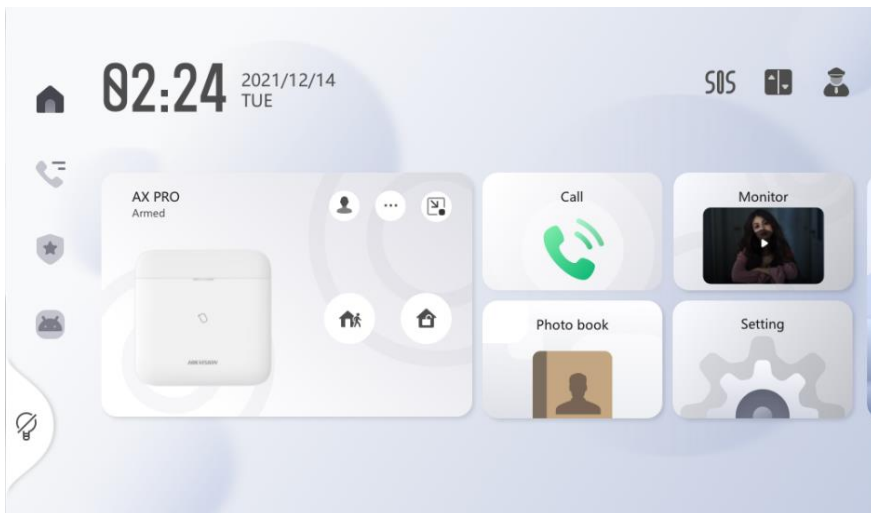

## 5. Notice

We strongly recommend updating the door stations to latest baseline firmware before working with this Android indoor station.

### **Remarks:**

- Hikvision reserves the right to change, alter or withdraw the above notification without prior notice.
- Product design and specifications are subject to change without prior notice.
- The Hikvision firmware may contain errors known as errata which may cause the product to deviate from published specifications. Current characterized errata are available on request.
- Hikvision is not liable for any typing or printing errors.

Hikvision Digital Technology CO., Ltd.  
No. 555 Qianmo Road, Binjiang District, Hangzhou 310051,  
China  
Tel: +86-571-8807-5998  
FAX: +86-571-8993-5635  
Email: [overseabusiness@hikvision.com](mailto:overseabusiness@hikvision.com)