

## KV9 Villa Door Station V2.3.5\_build221230 Release Note (2023-01-05)

### Firmware Basic Information

<b>Firmware Basic Information</b>	Firmware Version	V2.3.5_build221230
	Device Type	DS-KV9503-WBE1

### Reason of Upgrade

Fix bugs, enhance products quality and meet customers' requirements.

### Modified Features

1. Fix known device security vulnerability issues.

## KV9 Villa Door Station V2.3.5\_build221031 Release Note (2022-11-05)

### Firmware Basic Information

<b>Firmware Basic Information</b>	Firmware Version	V2.3.5_build221031
	Device Type	DS-KV9503-WBE1

### Reason of Upgrade

New model DS-KV9503-WBE1 villa door station first time released.



## New Features

1. 4.3 inch colorful IPS touch screen, 2 MP wide-angle dual-lens HD camera with WDR feature;
2. Higher protection level, IP65 & IK08
3. Multiple authentication methods: card, face, PIN code and QR code, (only support QR code generated from HikCentral visitor module)
4. Internal Mifare card reader, 1 physical button to call Indoor station/Center
5. Standard PoE or 12 VDC power supply
6. Up to 20,000 contacts, 20,000 faces, 100,000 card can be added to the device

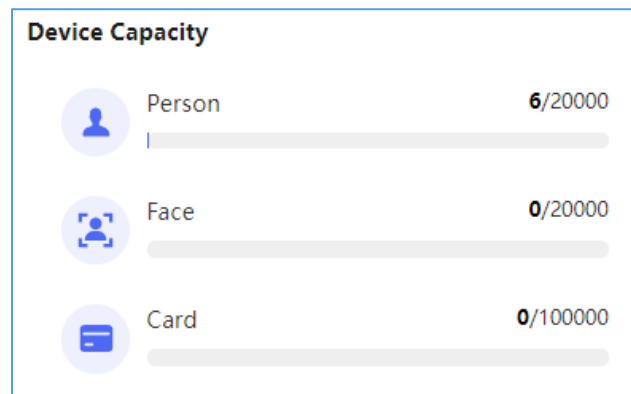

7. Brand new web5.0 interface

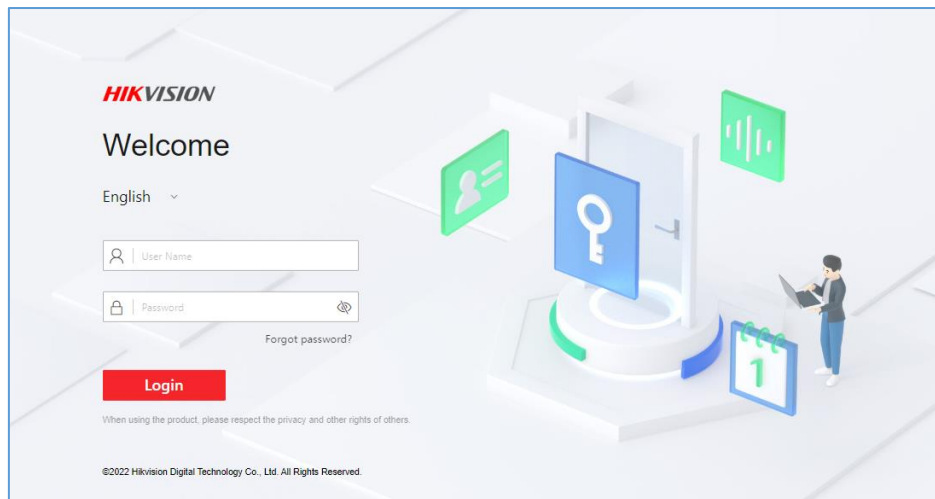

8. If device and mobile phone are in same network, you can login device mobile web from browser.  
**Note:** Not support deleting face picture in mobile web interface, you can only add or modify.

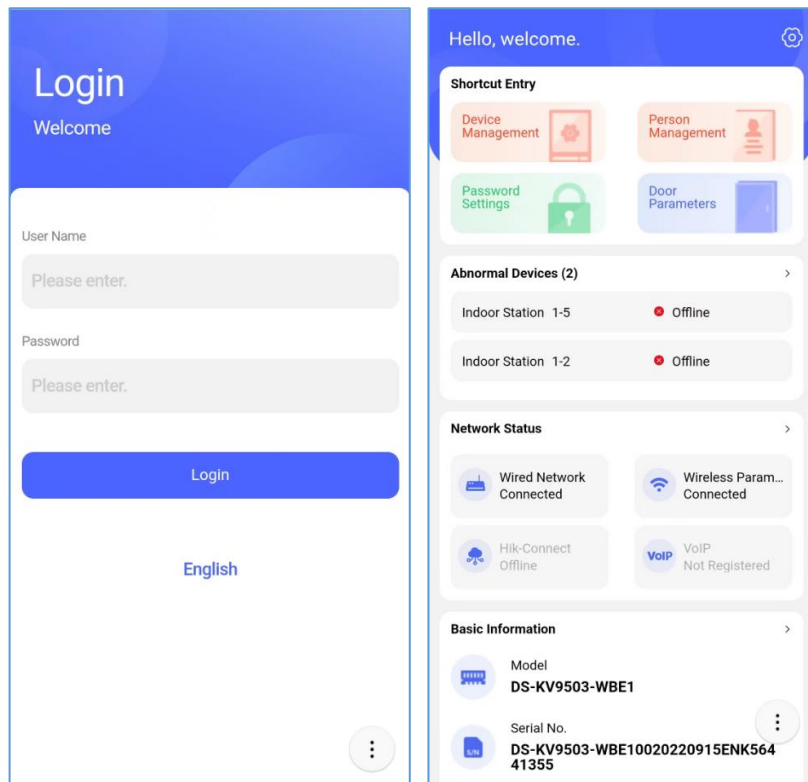

9. Support internal SADP function, you can search devices in same network, select device and add to door station directly.

**Note:** You can't see the devices which has same ip address as the villa door station

No.	Device Type	IP	Serial No.	Model	Current Version	Fl.	Roo...	Related No.	No.	Arming Status	User Name	Network...	Upgrade Status	Operation
1	Door Station	10.9.96.113	K46899526	DS-KD8003-IME1(B)012022021R...	V2.2.58build 220929	1	5	--	--	Offline	admin	Offline	/	⚙️ 🗑️
2	Door Station	10.9.96.183	D07561034	DS-KD8003-IME10120190407RRD...	V2.2.58build 220713	1	2	--	--	Offline	admin	Offline	/	⚙️ 🗑️
3	Door Station	10.9.96.105	K62953091	DS-KD8003Y-IME2012020926RR...	V2.2.58build 221020	1	2	--	--	Offline	admin	Offline	/	⚙️ 🗑️
4	Indoor Station	10.9.96.37	Q01754989	DS-KHE320-TE10120200303VRQ0...	V2.2.2build 221129	1	2	--	--	Offline	admin	Offline	/	⚙️ 🗑️
5	Indoor Station	10.9.96.71	Q12390458	DS-KHE320-WTDE10120220401W...	V2.1.42build 220615	1	2	--	--	Offline	admin	Offline	/	⚙️ 🗑️
6	Indoor Station	192.168.36.227	Q16428890	DS-KHE320EY-WTE20120220926...	V2.2.2build 221128	1	2	--	--	Offline	admin	Offline	/	⚙️ 🗑️
7	Indoor Station	10.9.96.34	Q06409255	DS-KHE520-WTE10120210420WR...	V2.2.2build 221129	1	2	--	--	Offline	admin	Offline	/	⚙️ 🗑️
8	Door Station	10.9.96.177	E50048552	DS-KV6113-WPE1(B)012020120TR...	V2.2.53build 220901	1	2	--	--	Offline	admin	Offline	/	⚙️ 🗑️
9	Door Station	10.9.96.192	K69738338	DS-KV8413-WME1(C)0120221009...	V2.2.57build 220816	1	2	--	--	Offline	admin	Offline	/	⚙️ 🗑️

10. Support contact function

**Note:** The device will have different UI interface display depending on the number of indoor units added.

1) If added indoor station quantity is less than 4 (include 4), the user will show as nametag.

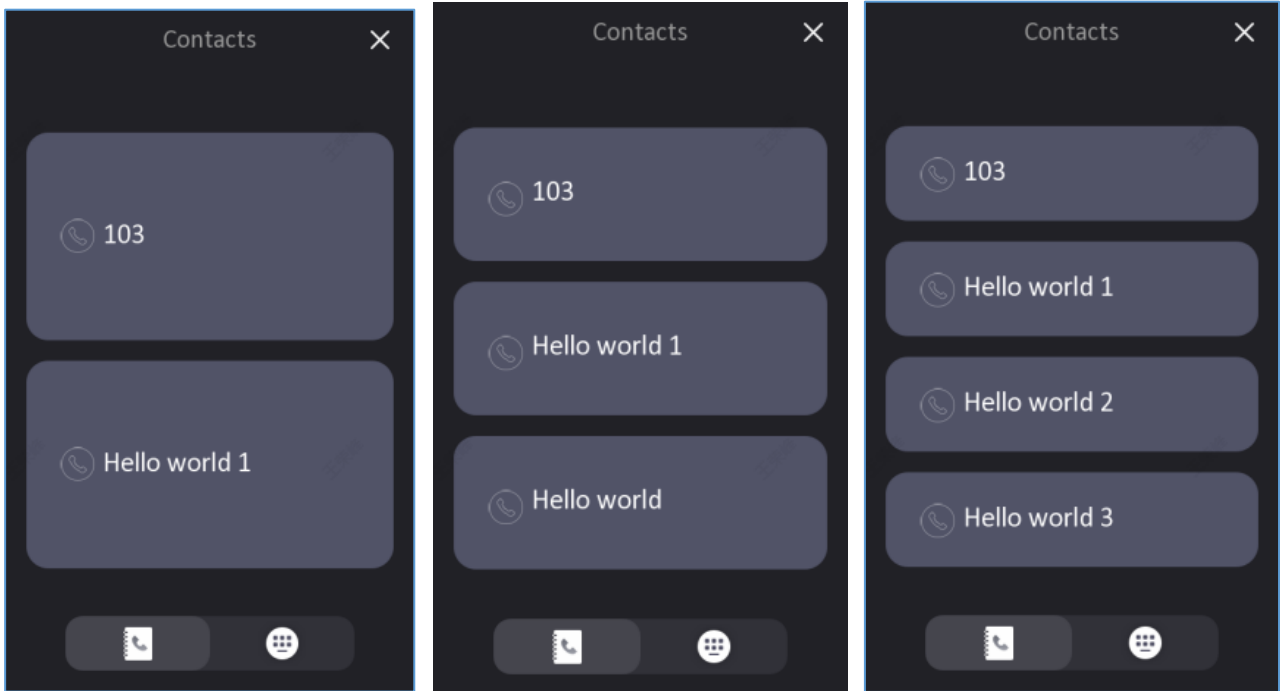

2) If added indoor station quantity is more than 5 (include 5), the user will show as contact list. Or you can also switch to keypad mode to input room number manually.

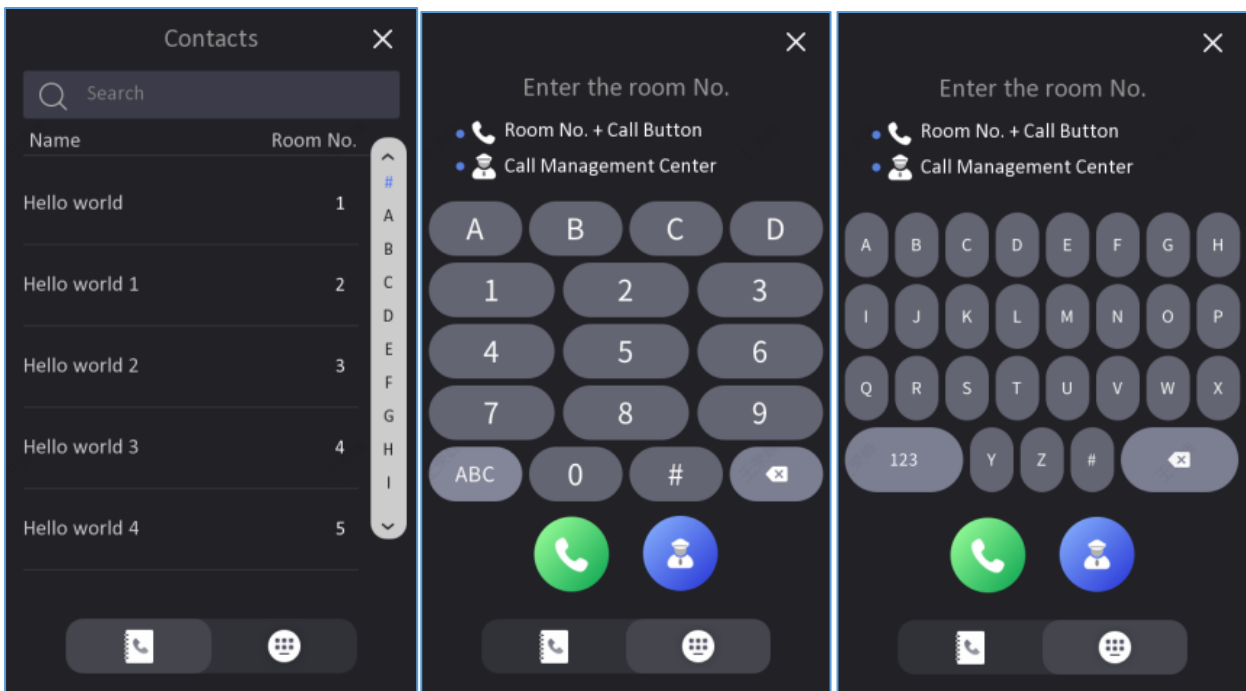

11. Support linking indoor station to room number with letters, then you can dial the linked room number in keypad mode.

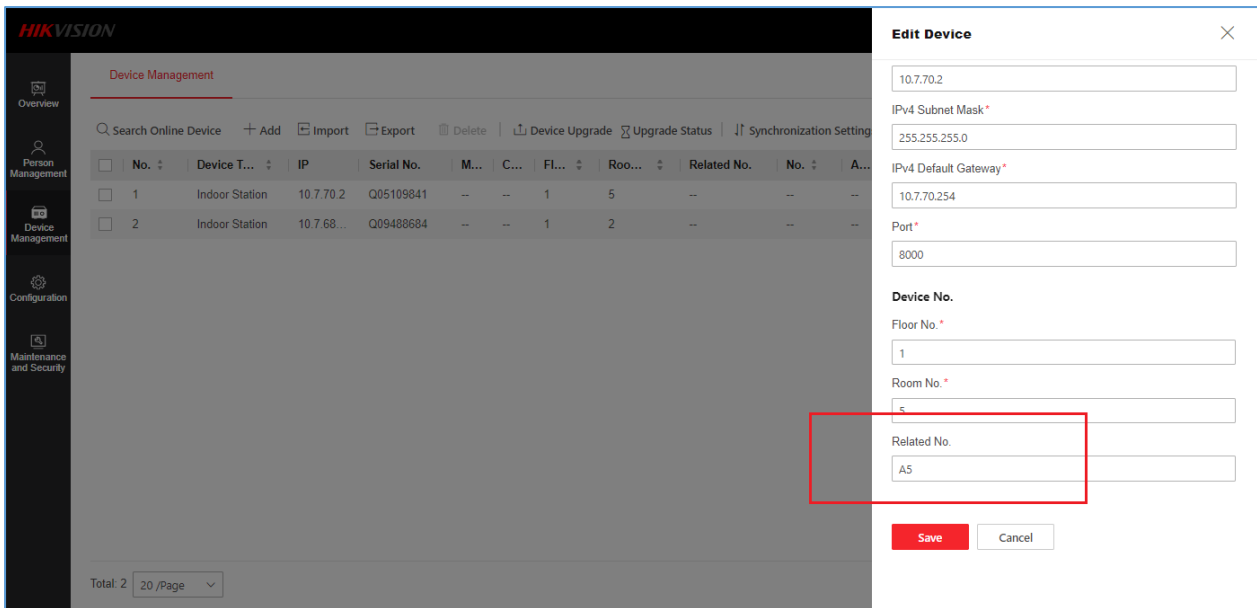

12. Support Bluetooth function which allows you to open door from mobile phone APP (this function will be available in future firmware and APP version)

13. Support 3<sup>rd</sup> stream with H.265 decoding format while the main and sub stream are still H.264 format

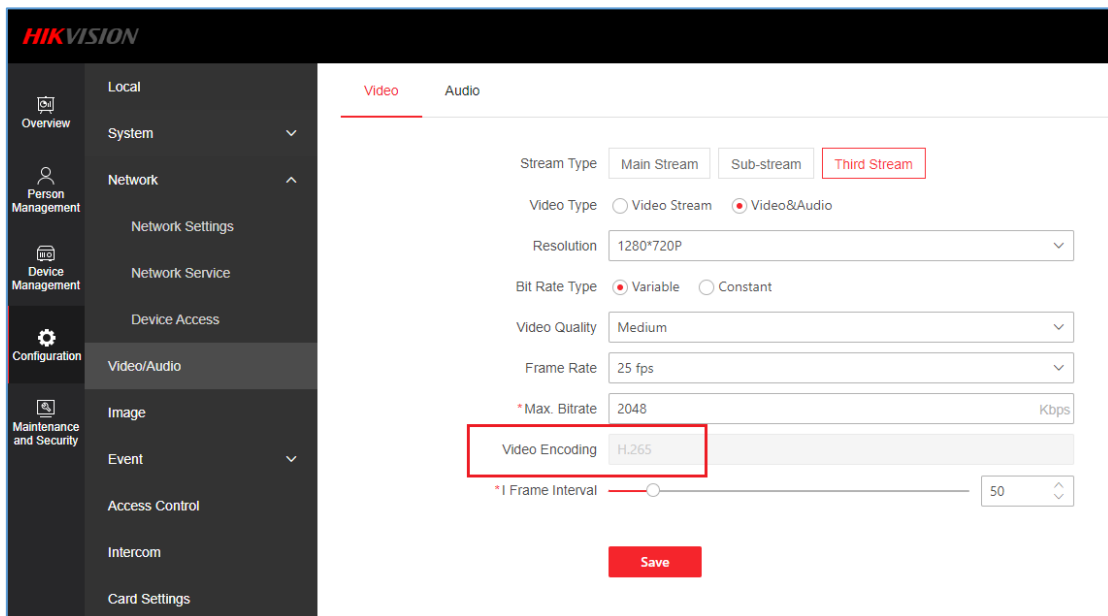

14. Wi-Fi module has 2 modes, Wi-Fi mode or AP mode. You can change it from web interface

**Note:** if you enable hotspot mode, the Wi-Fi will disconnect.

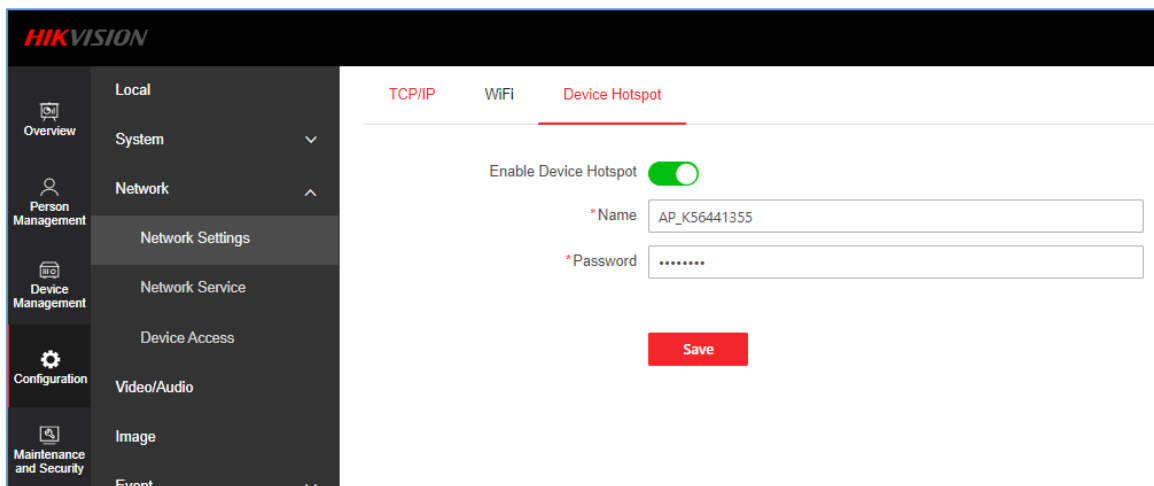
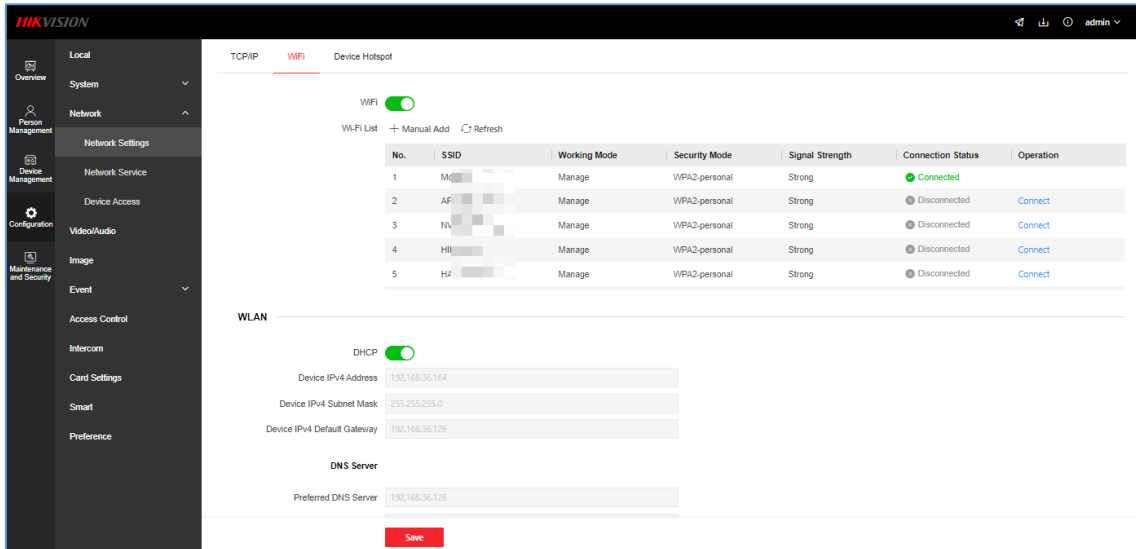

15. Support 2 modes for main interface (live view mode or custom mode), if you select custom mode, it will not display when you verify with face.

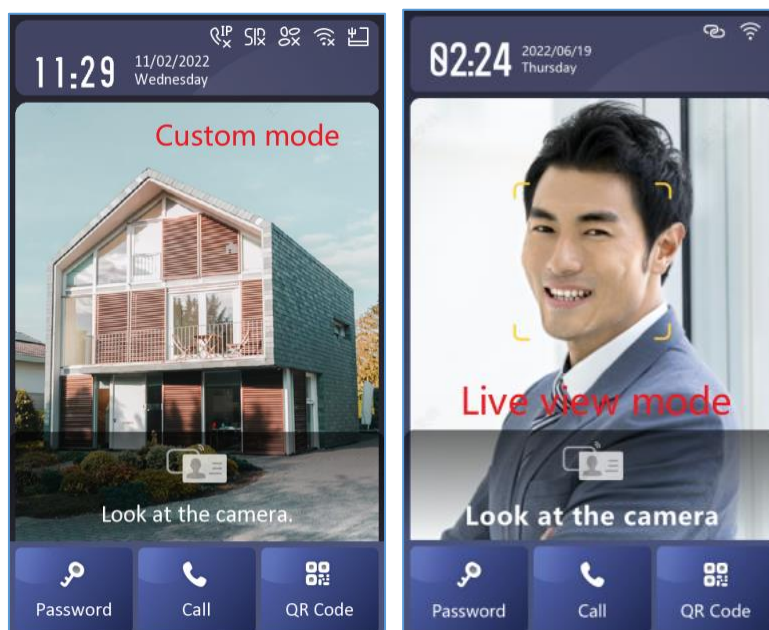

16. Enable or disable QR/Face verification and Call Center short cut key function from web or local menu.

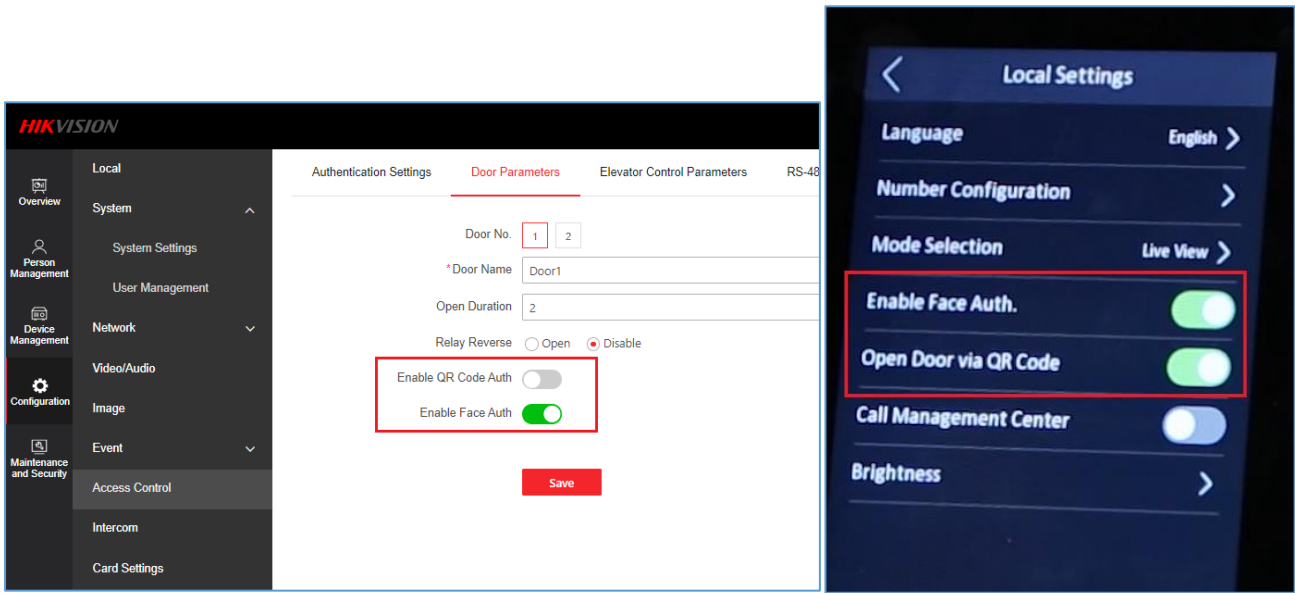

17. Support call schedule for the physical call button

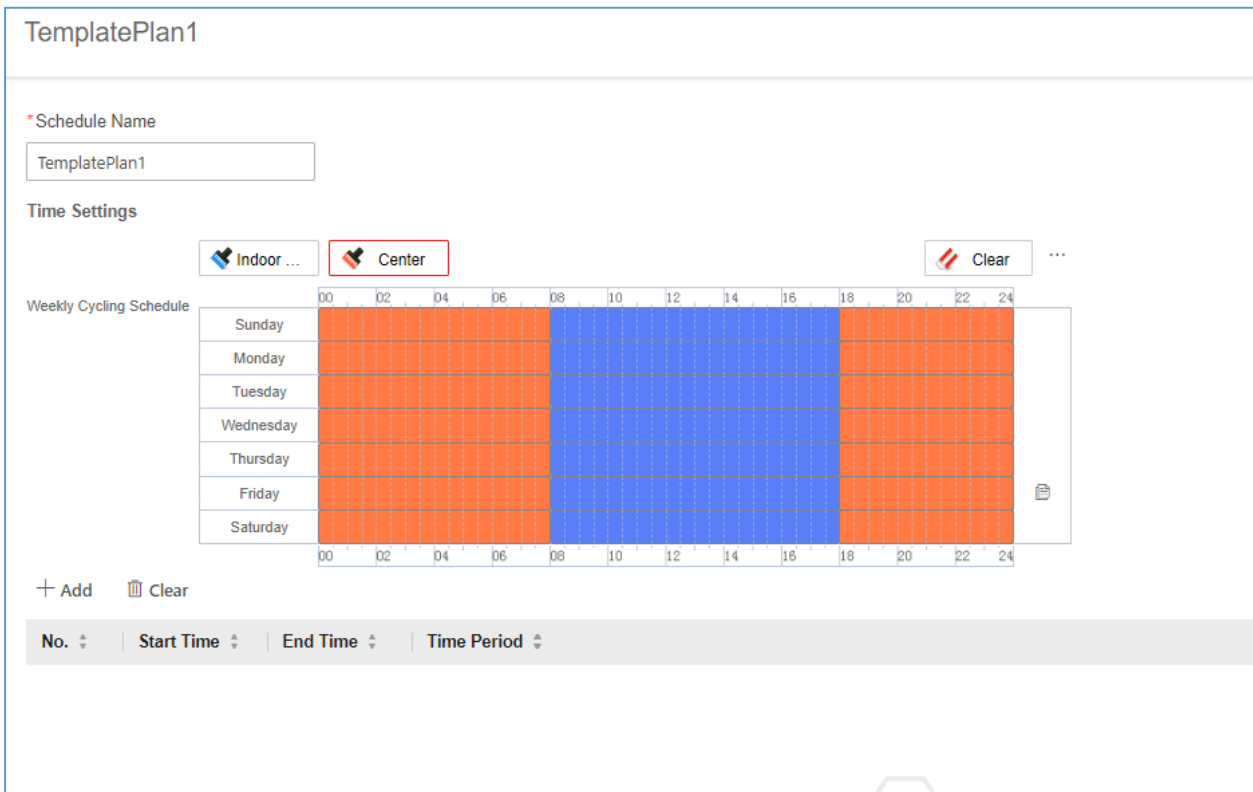

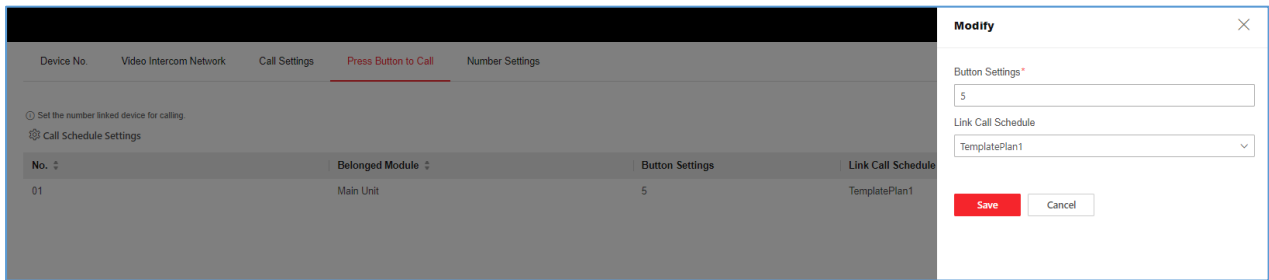

## Notice

We strongly recommend updating the door stations to latest baseline firmware

### Customer Impact and Recommended Action

This update refers to function/compatibility improvement and will take effect automatically after the Date of Change. We are very sorry for any inconvenience of use-habit changes caused by this action.

For any questions and request for this firmware, please contact our local technical support team.



Note:

- Hikvision reserves the right to change, alter or withdraw the above notification without prior notice.
- Product design and specifications are subject to change without prior notice.
- The Hikvision firmware may contain errors known as errata, which may cause the product to deviate from published specifications. Current characterized errata are available on request.
- Hikvision is not liable for any typing or printing errors.

Hikvision Digital Technology CO., Ltd.  
No. 555 Qianmo Road, Binjiang District, Hangzhou 310051,  
China  
Tel: +86-571-8807-5998  
FAX: +86-571-8993-5635  
Email: [overseabusiness@hikvision.com](mailto:overseabusiness@hikvision.com)