

DS-K1T343 Series MinMoe Terminal Release Notes (2022-04-09)

Device Model: DS-K1T343EX, DS-K1T343EWX DS-K1T343EFX, DS-K1T343EFWX DS-K1T343MX, DS-K1T343MWX DS-K1T343MFX, DS-K1T343MFWX Naming Rule: M for M1 card, F for fingerprint, W for Wi-Fi	Firmware Version	ACS_343_F1pro_EN_STD_V3.3.4_build220310 ACS_343_F1pro_EN_NEU_V3.3.4_build220310
	SDK	Latest baseline version
	iVMS-4200 Version	Latest baseline version

Reason of Upgrade

Fix bugs, enhance products quality and meet customers' requirements.

Modified Features

1. Optimize fingerprint module performance.

DS-K1T343 Series MinMoe Terminal Release Notes (2022-03-09)

Device Model: DS-K1T343EX, DS-K1T343EWX DS-K1T343EFX, DS-K1T343EFWX DS-K1T343MX, DS-K1T343MWX DS-K1T343MFX, DS-K1T343MFWX Naming Rule: M for M1 card, F for fingerprint, W for	Firmware Version	ACS_343_F1pro_EN_STD_V3.3.4_build220210 ACS_343_F1pro_EN_NEU_V3.3.4_build220210
	SDK	Latest baseline version

Wi-Fi	iVMS-4200 Version	Latest baseline version
-------	----------------------	-------------------------

Reason of Upgrade

Fix bugs, enhance products quality and meet customers' requirements.

Modified Features

2. Fix the problem that the device cannot wake up occasionally after running for a long time;

DS-K1T343 Series MinMoe Terminal Release Notes (2022-02-09)

Device Model: DS-K1T343EX, DS-K1T343EWX DS-K1T343EFX, DS-K1T343EFWX DS-K1T343MX, DS-K1T343MWX DS-K1T343MFX, DS-K1T343MFWX Naming Rule: M for M1 card, F for fingerprint, W for Wi-Fi	Firmware Version	ARM : ACS_343_F1pro_EN_STD_V3.3.4_build211229 ACS_343_F1pro_EN_NEU_V3.3.4_build211229
	SDK	Latest baseline version
	iVMS-4200 Version	Latest baseline version

Reason of Upgrade

Fix bugs, enhance products quality and meet customers' requirements.

Modified Features

1. Update the driver to be compatible with new fingerprint materials;
2. Fix some ISAPI protocol bugs

DS-K1T343 Series MinMoe Terminal Release Notes (2021-10-23)

Device Model: DS-K1T343EX, DS-K1T343EWX DS-K1T343EFX, DS-K1T343EFWX DS-K1T343MX, DS-K1T343MWX DS-K1T343MFX, DS-K1T343MFWX Naming Rule: M for M1 card, F for fingerprint, W for Wi-Fi	Firmware Version	ARM : ACS_343_F1pro_EN_STD_V3.3.4_build211022 ACS_343_F1pro_EN_NEU_V3.3.4_build211022
	SDK	Latest baseline version
	iVMS-4200 Version	Latest baseline version

Reason of Upgrade

Fix bugs, enhance products quality and meet customers' requirements.

Modified Features

3. Update the driver to be compatible with new fingerprint materials;

DS-K1T343 Series MinMoe Terminal Release Notes (2021-09-17)

Device Model: DS-K1T343EX, DS-K1T343EWX DS-K1T343EFX, DS-K1T343EFWX DS-K1T343MX, DS-K1T343MWX DS-K1T343MFX, DS-K1T343MFWX Naming Rule: M for M1 card, F for fingerprint, W for Wi-Fi	Firmware Version	ARM : ACS_343_F1pro_EN_STD_V3.3.4_build210812 ACS_343_F1pro_EN_NEU_V3.3.4_build210812
	SDK	Latest baseline version
	iVMS-4200 Version	Latest baseline version

Reason of Upgrade

New model DS-K1T343 series MinMoe terminal first time released.



New Features

1. 4.3 inch capacitive touch screen with large screen ratio, 2 MP wide-angle dual-lens camera with WDR feature;
2. Connect external card reader or access controller via RS485 protocol; support Wiegand26/34 output
3. Face recognition duration < 0.2 s/User; face recognition accuracy rate ≥ 99%
4. **Face, card, fingerprint, event capacity**

	Face	Card	Fingerprint	Event	Wi-Fi
DS-K1T343EX	1,500	3,000(EM)	Not support	150,000	Not support
DS-K1T343EWX			Not support		Support
DS-K1T343EFX			1,500		Not support
DS-K1T343EFWX			1,500		Support
DS-K1T343MX		3,000(M1)	Not support		Not support
DS-K1T343MWX			Not support		Support
DS-K1T343MFX			1,500		Not support
DS-K1T343MFWX			1,500		Support

5. **ISAPI** protocol makes it easier for integration with third-party software;
6. Remote video intercom and unlock door from **Hik-Connect App** on your mobile/Pad
7. Support **Hik-ProConnect** platform to realize Cloud access control and time attendance management
8. Support **ISUP 5.0** protocol to manage devices located in different locations;
9. When open device for the first time, wizard for activation and basic configuration. Including select language, application mode, select and configure network, Hik-Connect, privacy settings, add administrator face and card

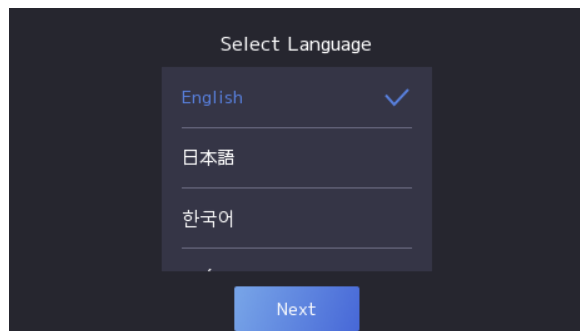
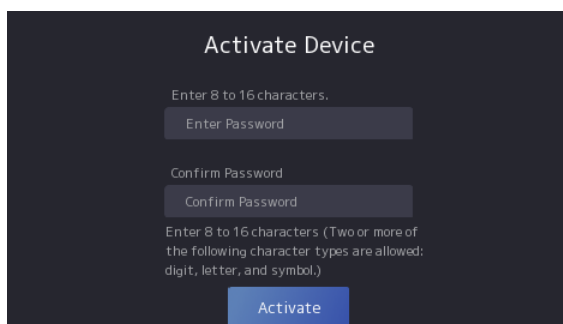

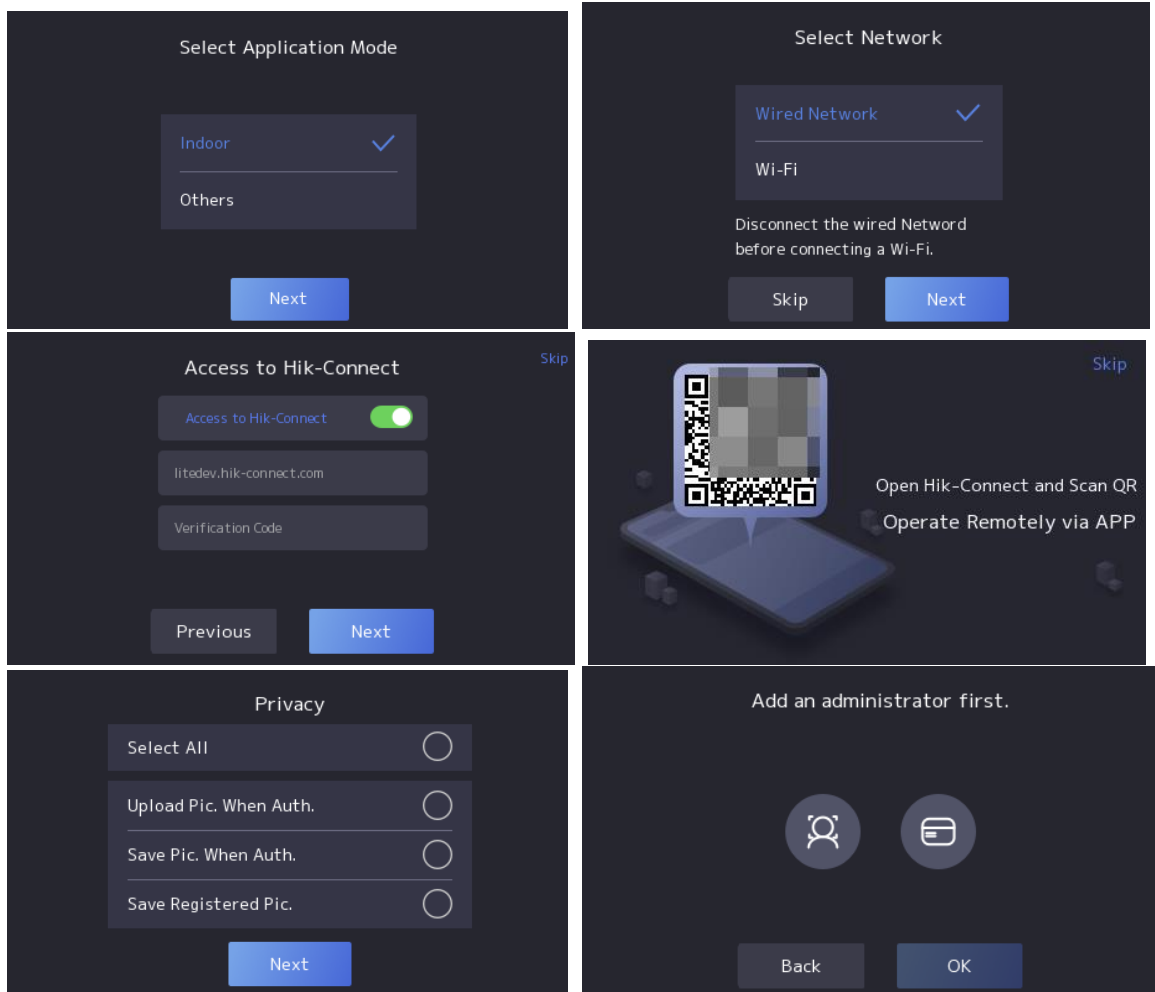

10. Self-defined shortcut key (Call Room, Call Center, Call Specified Room, Call App and Password) on main interface;

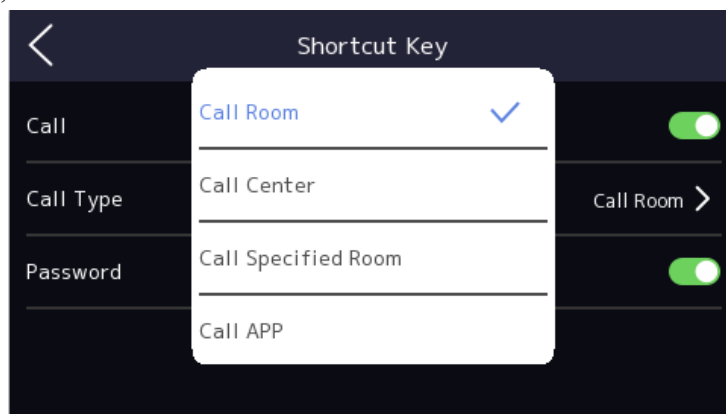

11. Configure ISUP and Hik-Connect parameter in device local menu

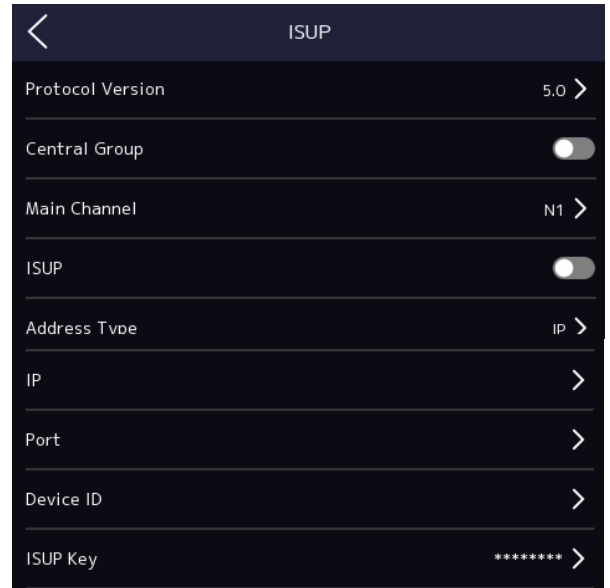
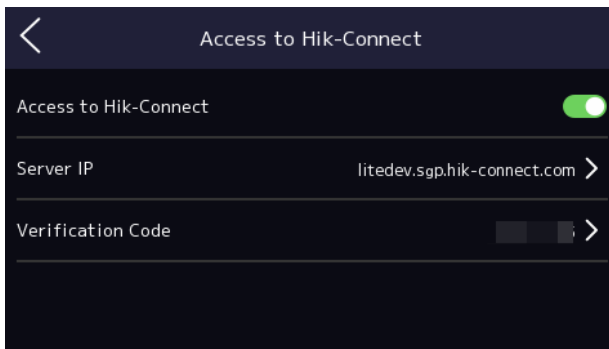
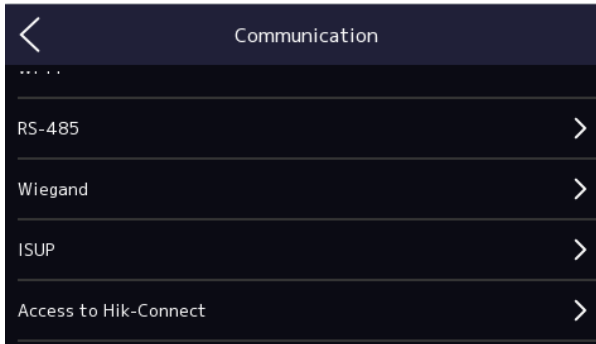

12. Login and configure device in web client via **PC/mobile browser**;(mobile phone should connect same network with device)

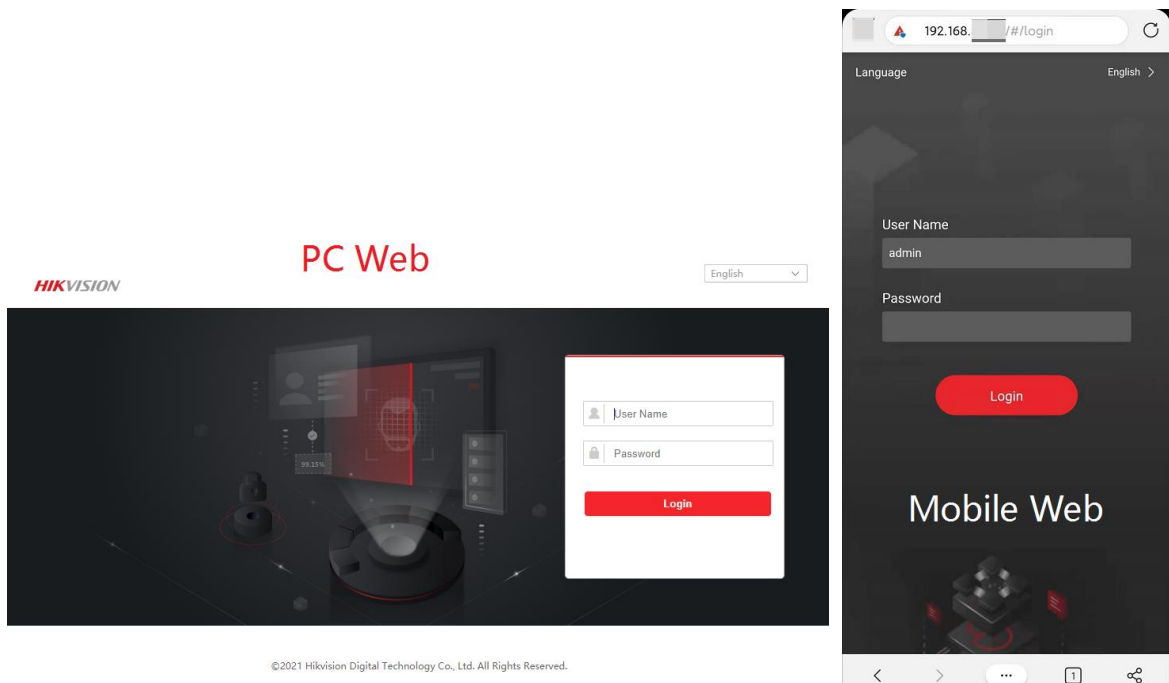

13. Self-defined voice prompt (TTS function, English only) and screen display info (user ID, name and face picture) for authentication;

14. Network

Support TCP/IP, adapt to LAN(network) or WAN(ISUP 5.0) network environment

15. Function

- a. Support face mask recognition.
- b. **Video intercom** with indoor station, master station and platform;
- c. Multiple verification modes: Face, card, fingerprint(-F only), PIN code;
- d. Face recognition distance ranges from 0.3 to 1.5 meters;
- e. Support check in/check out/break out/break in/overtime in/overtime out attendance status, and self-define status name;

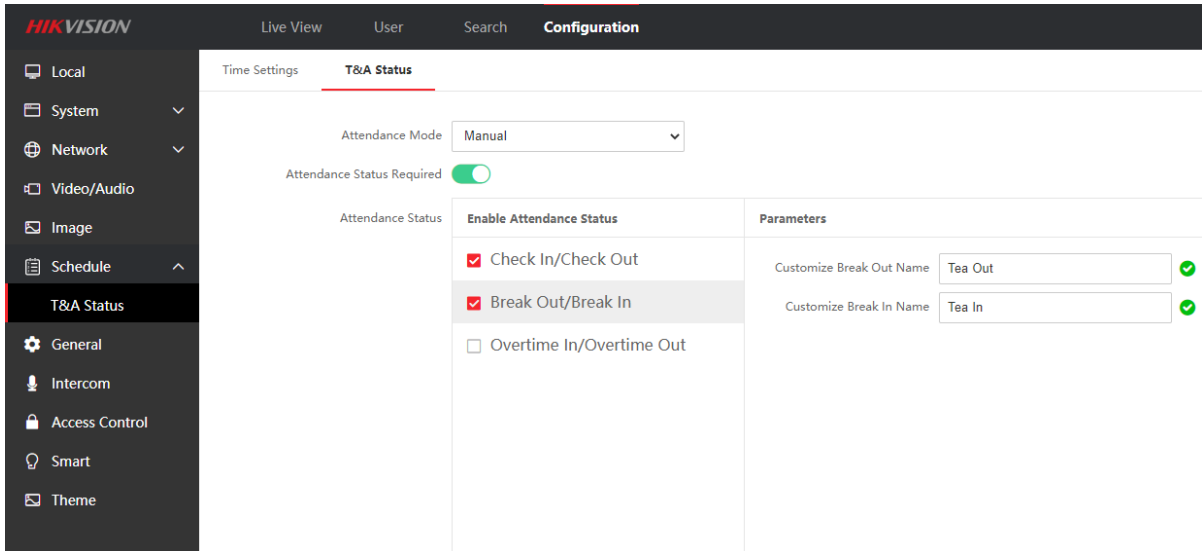

- f. Support custom standby background image (max 8 pictures)

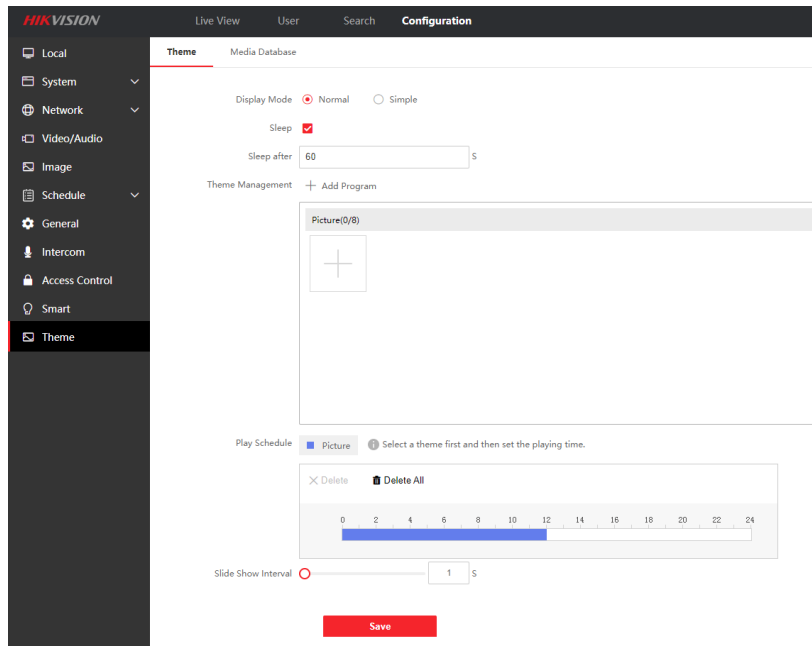

- g. Support privacy protection, customer can define the privacy related parameter, such as Event Storage Settings, Picture Uploading and Storage, Clear All Pictures in Device

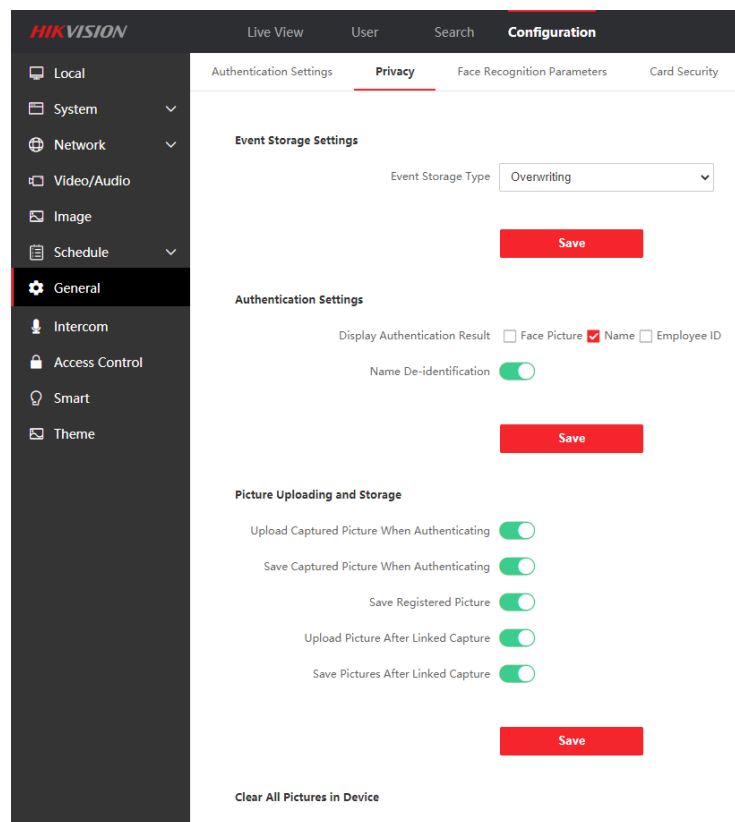

- h. Supports face recognition in low illumination
- i. Supports live view on the platform, H.264

Customer Impact and Recommended Action

This update refers to function/compatibility improvement and will take effect automatically after the Date of Change. We are very sorry for any inconvenience of use-habit changes caused by this action. For any questions and request for this firmware, please contact our local technical support team.

Note:

- Hikvision reserves the right to change, alter or withdraw the above notification without prior notice.
- Product design and specifications are subject to change without prior notice.
- The Hikvision firmware may contain errors known as errata, which may cause the product to deviate from published specifications. Current characterized errata are available on request.
- Hikvision is not liable for any typing or printing errors.

Hikvision Digital Technology CO., Ltd.
No. 555 Qianmo Road, Binjiang District, Hangzhou 310051,
China
Tel: +86-571-8807-5998
FAX: +86-571-8993-5635
Email: overseabusiness@hikvision.com