

DS-K1T673 Series MinMoe Terminal

Release Notes (2022-06-10)

Device Model: DS-K1T673DX, DS-K1T673DWX, DS-K1T673TDX, DS-K1T673TDWX Modules (optional): DS-KAB673-B, DS-KAB673-BQR DS-KAB673-FB, DS-KAB673-FBQR Naming Rule: D for Desfire, Felica and M1 card W for Wi-Fi, F for Fingerprint, B for Bluetooth, QR for QR code	Firmware Version	ARM: ACS_673_F1plus_EN_STD_V3.3.1_build220610 ACS_673_F1plus_EN_NEU_V3.3.1_build220610 Sub module: ACS_DS- KAB673_ST1_GML_GM_V1.0.2_build20220505
	SDK	Latest baseline version
	iVMS-4200 Version	Latest baseline version

Reason of Upgrade

Fix bugs, enhance products quality and meet customers' requirements.

Modified Features

1. Compatible with new 4G module.(the sim card function is reserved)

DS-K1T673 Series MinMoe Terminal

Release Notes (2022-02-14)

Device Model: DS-K1T673DX, DS-K1T673DWX, DS-K1T673TDX, DS-K1T673TDWX Modules (optional): DS-KAB673-B, DS-KAB673-BQR DS-KAB673-FB, DS-KAB673-FBQR Naming Rule: D for Desfire, Felica and M1 card W for Wi-Fi, F for Fingerprint, B for Bluetooth, QR for QR code	Firmware Version	ARM: ACS_673_F1plus_EN_STD_V3.3.1_build220120 ACS_673_F1plus_EN_NEU_V3.3.1_build220120 Sub module: ACS_DS- KAB673_ST1_GML_GM_V1.0.1_build20211115
	SDK	Latest baseline version
	iVMS-4200 Version	Latest baseline version

Reason of Upgrade

Fix bugs, enhance products quality and meet customers' requirements.

Modified Features

2. Optimize Wi-Fi function;
3. Fixed the problem of abnormal URL ID parsing when applying a large number of people to the device
4. Optimized the firmware upgrade mechanism

DS-K1T673 Series MinMoe Terminal Release Notes (2021-12-03)

Device Model: DS-K1T673DX, DS-K1T673DWX, DS-K1T673TDX, DS-K1T673TDWX Modules (optional): DS-KAB673-B, DS-KAB673-BQR DS-KAB673-FB, DS-KAB673-FBQR Naming Rule: D for Desfire, Felica and M1 card W for Wi-Fi, F for Fingerprint, B for Bluetooth, QR for QR code	Firmware Version	ARM: ACS_673_F1plus_EN_STD_V3.3.1_build211123 ACS_673_F1plus_EN_NEU_V3.3.1_build211123 Sub module: ACS_DS-KAB673_ST1_GML_GM_V1.0.1_build20211115
	SDK	Latest baseline version
	iVMS-4200 Version	Latest baseline version

Reason of Upgrade

Fix bugs, enhance products quality and meet customers' requirements.

Modified Features

1. Fixed some ISAPI protocol issue

DS-K1T673 Series MinMoe Terminal

Release Notes (2021-11-15)

Device Model: DS-K1T673DX, DS-K1T673DWX, DS-K1T673TDX, DS-K1T673TDWX Modules (optional): DS-KAB673-B, DS-KAB673-BQR DS-KAB673-FB, DS-KAB673-FBQR Naming Rule: D for Desfire, Felica and M1 card W for Wi-Fi, F for Fingerprint, B for Bluetooth, QR for QR code	Firmware Version	ARM: ACS_673_F1plus_EN_STD_V3.3.1_build211101 ACS_673_F1plus_EN_NEU_V3.3.1_build211101 Sub module: ACS_DS-KAB673_ST1_GML_GM_V1.0.0_build20210812
	SDK	Latest baseline version
	iVMS-4200 Version	Latest baseline version

Reason of Upgrade

Fix bugs, enhance products quality and meet customers' requirements.

Modified Features

5. Fix the defect that the face/card/password cannot be configured when the USB module is not plugged in
6. Increase the volume of device voice prompts
7. Optimize the face recognition effect.
8. Optimize protocol defects with platform

DS-K1T673 Series MinMoe Terminal

Release Notes (2021-09-27)

Device Model: DS-K1T673DX, DS-K1T673DWX, DS-K1T673TDX, DS-K1T673TDWX Modules (optional): DS-KAB673-B, DS-KAB673-BQR DS-KAB673-FB, DS-KAB673-FBQR Naming Rule: D for Desfire, Felica and M1 card W for Wi-Fi, F for Fingerprint, B for Bluetooth, QR for QR code	Firmware Version	ARM: ACS_673_F1plus_EN_STD_V3.3.1_build210825 ACS_673_F1plus_EN_NEU_V3.3.1_build210825 Sub module: ACS_DS-KAB673_ST1_GML_GM_V1.0.0_build20210812
	SDK	Latest baseline version
	iVMS-4200 Version	Latest baseline version

Reason of Upgrade

New model DS-K1T673 series MinMoe terminal and USB modules are released for the first time.



New Features

1. 7-inch LCD touch screen, 2 MP wide-angle dual-lens camera with WDR feature;
2. Connect external card reader or access controller via RS485 protocol; support Wiegand26/34 output
3. Face recognition duration < 0.2 s/User; face recognition accuracy rate ≥ 99%

4. Face, card, fingerprint, event capacity

	Face	Card	Fingerprint	Event	Wi-Fi
DS-K1T673DX	10,000	50,000	10,000 (optional)	150,000	\
DS-K1T673DWX			With module DS-KAB673-FB		Support
DS-K1T673TDX	100,000	500,000	or DS-KAB673-FBQR		\
DS-K1T673TDWX					Support

5. ISAPI protocol makes it easier for integration with third-party software;
6. Remote video intercom and unlock door from Hik-Connect App on your mobile/Pad
7. Support Hik-ProConnect platform to realize Cloud access control and time attendance management
8. Support ISUP 5.0 protocol to manage devices located in different locations;
9. When open device for the first time, wizard for activation and basic configuration. Including select language, application mode, select and configure network, Hik-Connect, privacy settings, add administrator face and card.

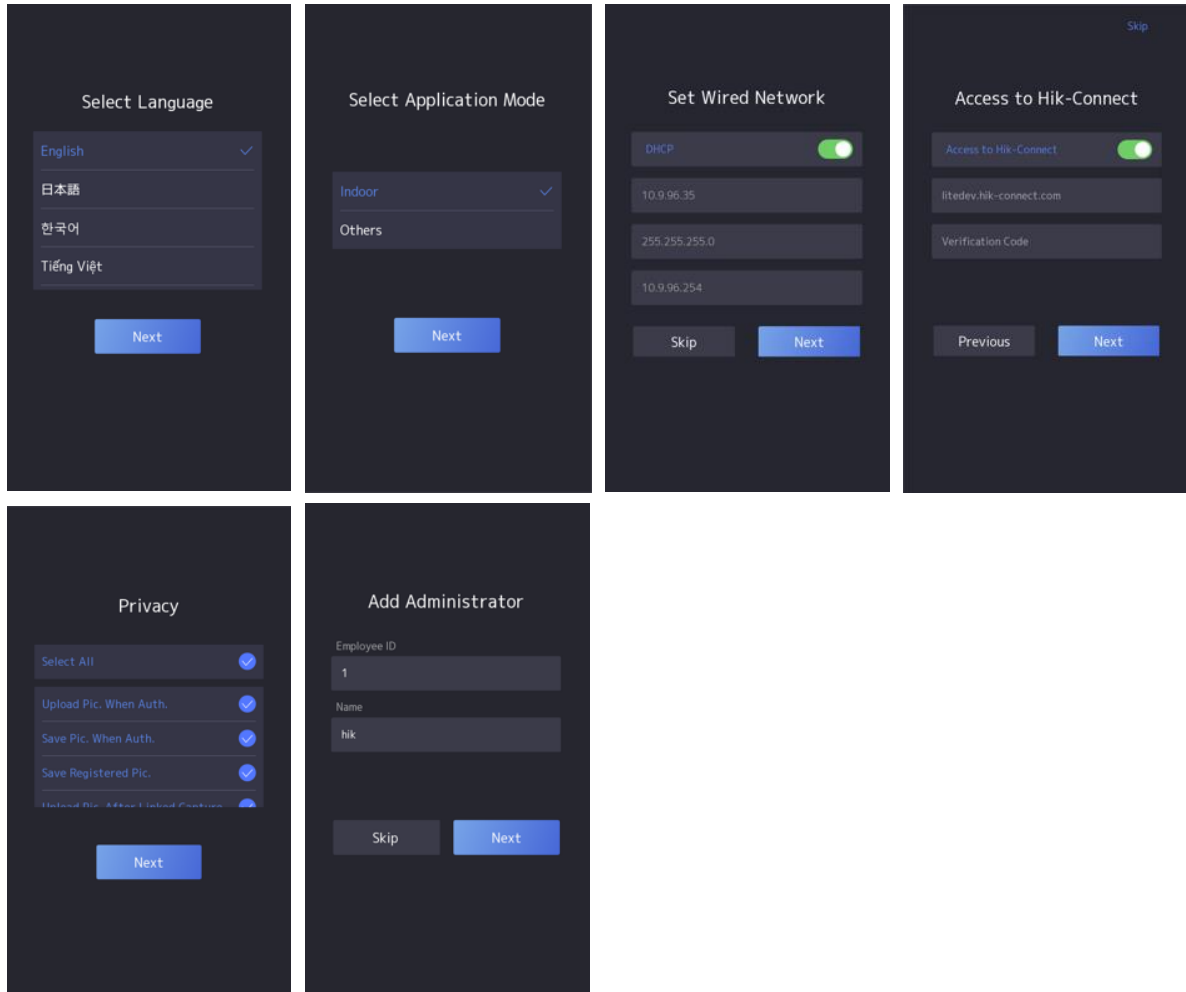

10. USB modules support hot plugging, optional QR (model with -QR), fingerprint(model with -F), and Bluetooth(model with -B) function.

Note:

- a. Bluetooth function will be available in future firmware to work together with mobile APP.
- b. Supported QR Code format: QR Code, Micro QR, Code128, Code39, Codabar
- c. How to authenticate QR code:
 - 1) When The QR code icon is displayed on the standby interface: click on the icon, and then show the QR code in the front of module;
 - 2) When hiding the QR code icon on the standby interface: show the QR code icon directly.

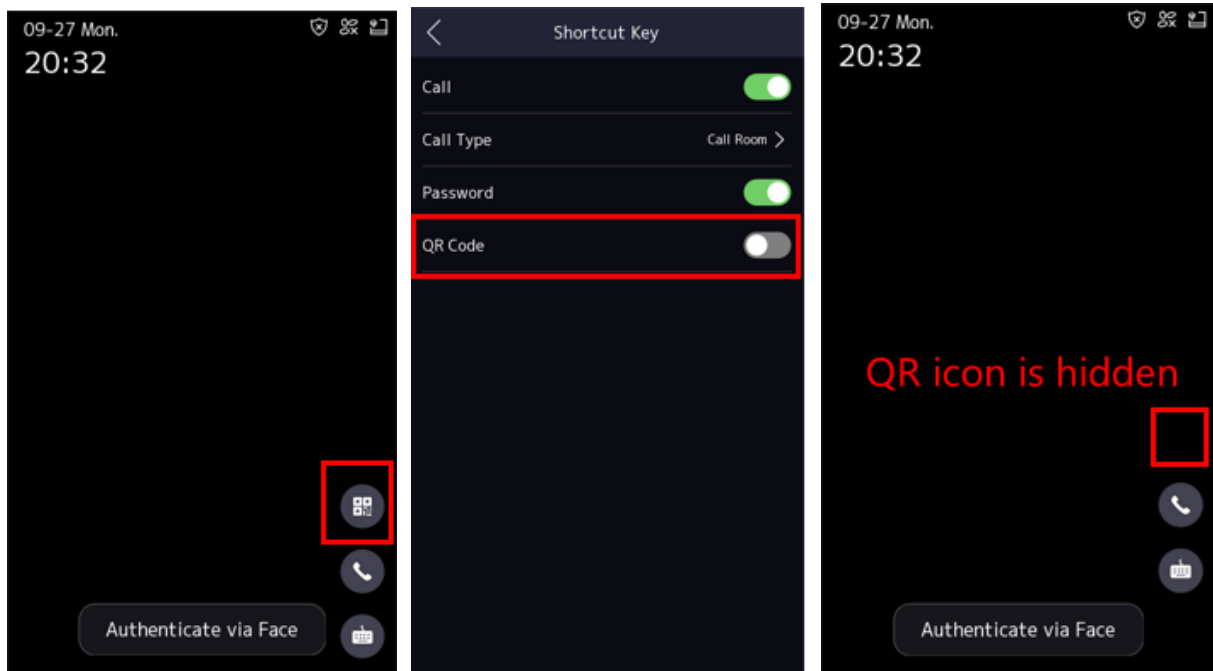

11. Support breathing light, it can be used to indicate the device position in the night
 - a. In the standby status, the breathing light will cycle from dark to bright, and then to dark.
 - b. When there is an authentication event, the breathing light will stay on for a while, and then the breathing indication state will be restored

12. Support 3.5mm standard audio output interface in the back of device.

Speakers can be connected externally, and the output sound can be played by the speakers. Supports hot plugging, which can be plugged in or unplugged at any time before and after the device is powered on. After the speaker is plugged in, the sound will be played by the speaker, and the sound will be played by the device's own amplifier when it is unplugged.

Special circumstances: When intercom function is enabled, whether or not a speaker is plugged in, the voice will be played locally by the device. (Prevent the echo interference)

13. Self-defined shortcut key (Call Room, Call Center, Call Specified Room, Call App and Password) on main interface;
14. Configure ISUP and Hik-Connect parameter in device local menu

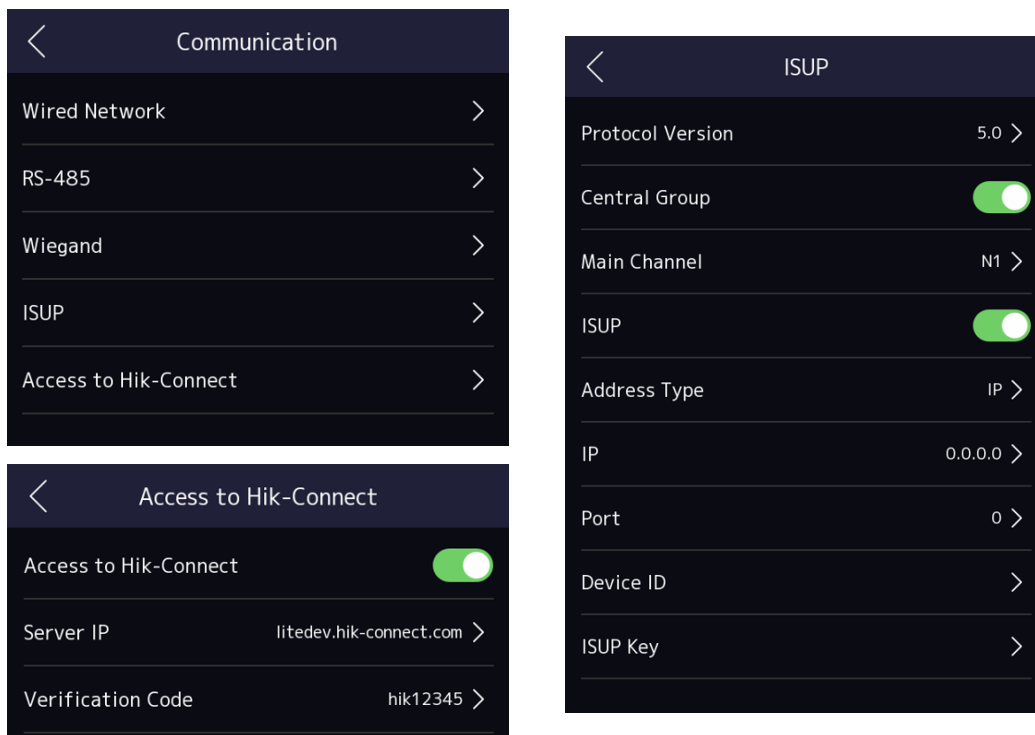

15. Login and configure device in web client via browser;



©2021 Hikvision Digital Technology Co., Ltd. All Rights Reserved.

16. Support multiple face authentication(maximum 5 person can be recognized at the same time)
Note: after enable the function, card reader authentication mode, custom authentication and attendance status function cannot be used.

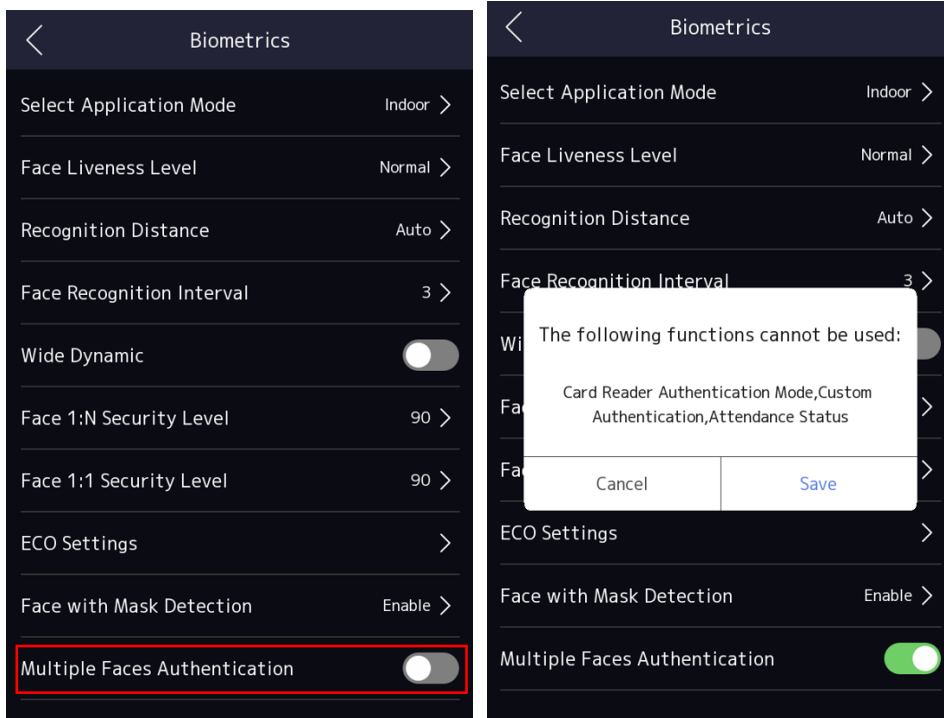

17. Support **call elevator** function.

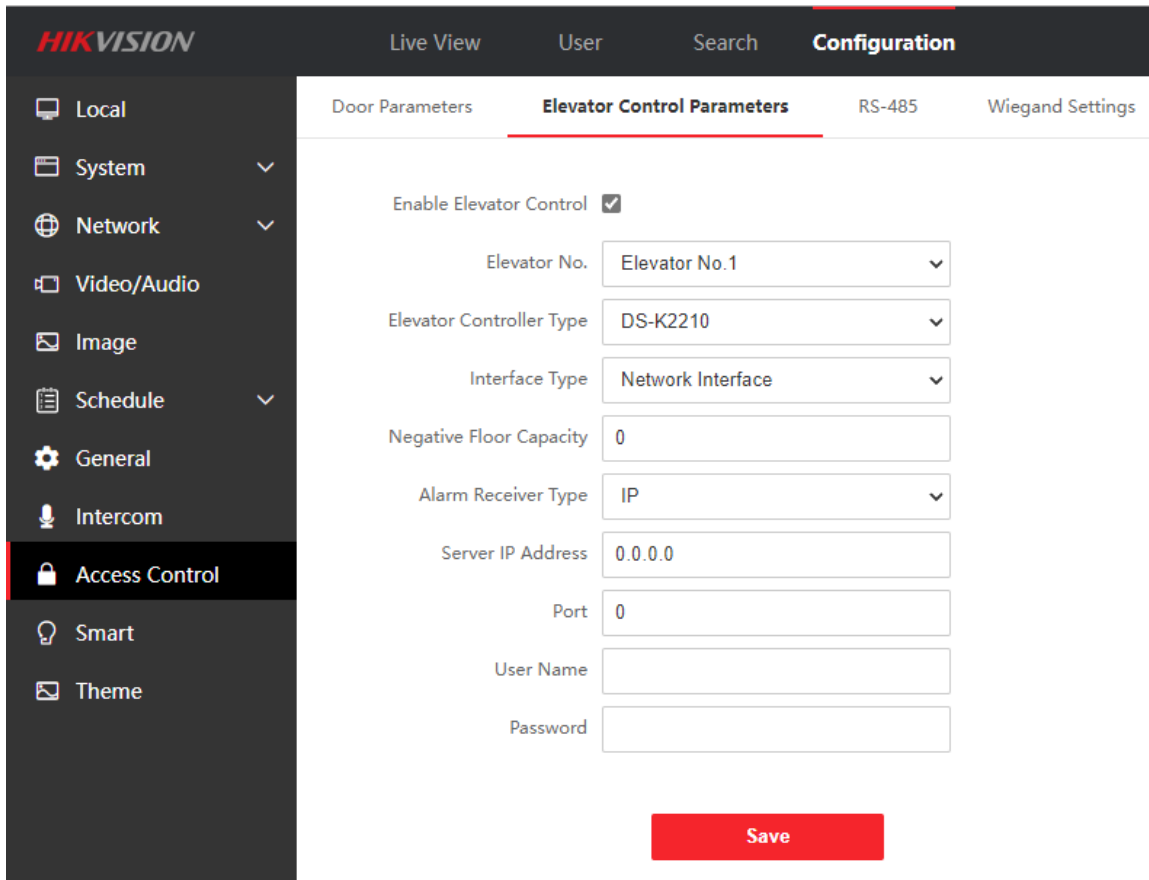

18. Self-defined voice prompt (TTS function, English only) and screen display info (user ID, name and face picture) for authentication.

19. Self-defined **welcome message** and picture and displayed by schedule.

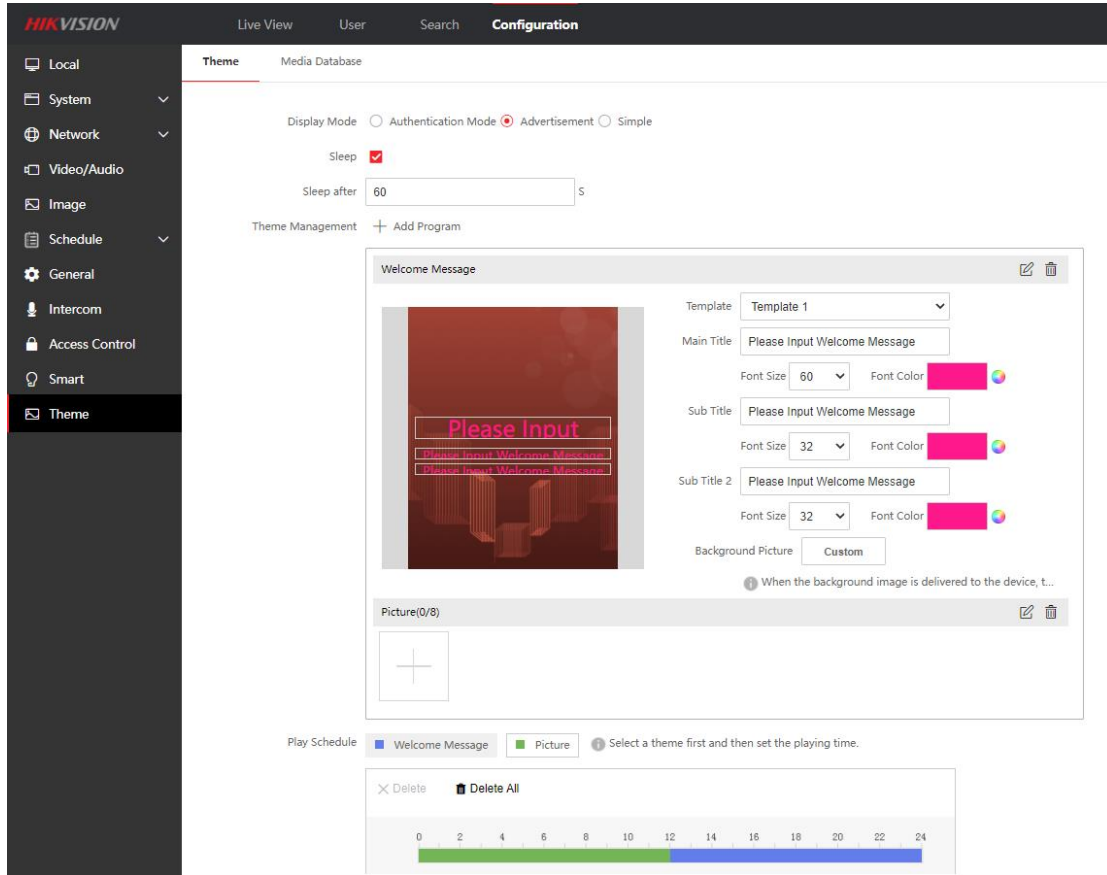

20. Support **simple mode**, **advertisement mode** when authenticating.

Default mode: Full screen live view when authenticating face

Simple mode: Display wallpaper on the top and no live view when authenticate face

Advertisement mode: The screen will display the wallpaper on the top area, and a small round circle area for live view in the bottom.

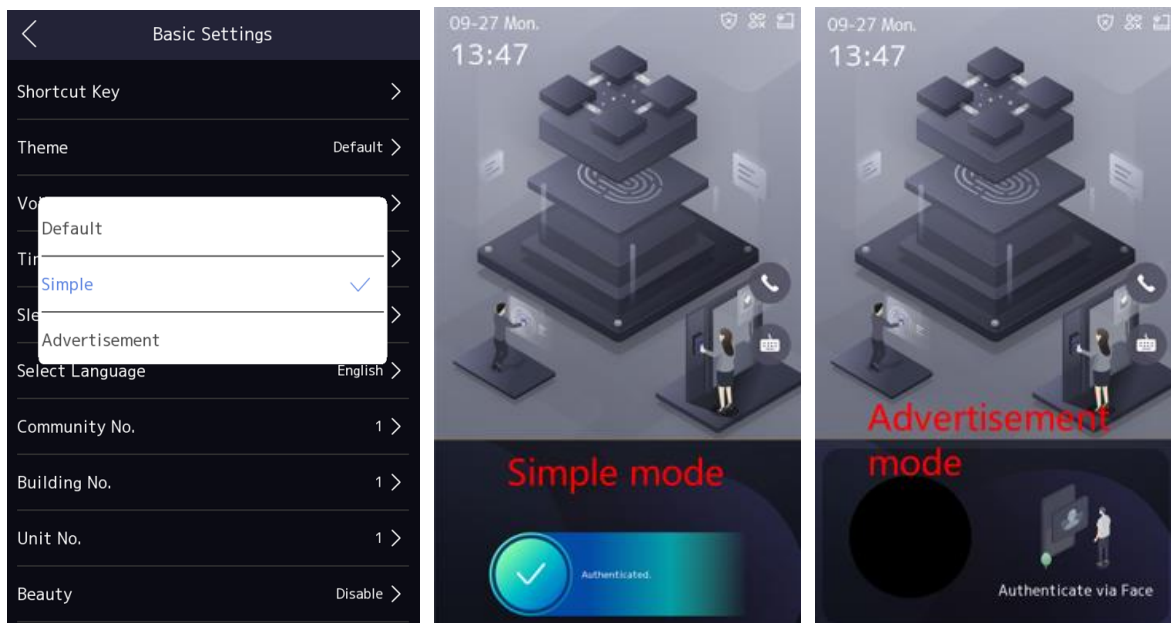

21. Network

Support TCP/IP(IPv4&IPv6), Wi-Fi (Model with -W), adapt to LAN(network) or WAN(ISUP 5.0) network environment

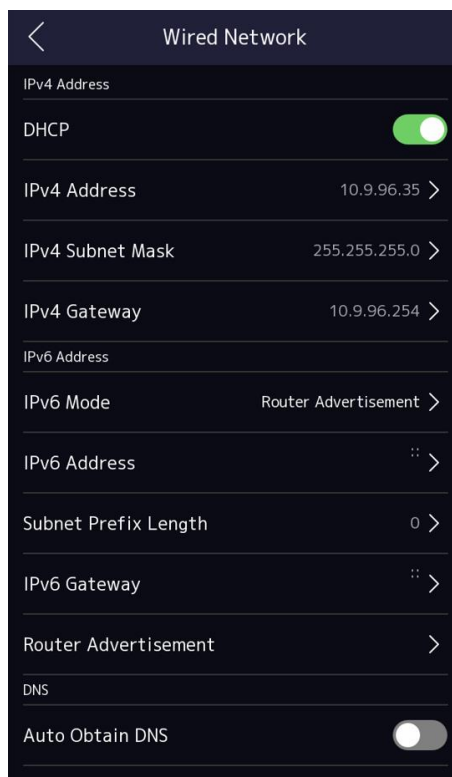

Note for IPv6:

Function	Ipv4	Ipv6
HTTP/HTTPS (80/443 port)	Support	Support
SDK (8000/8443 port)	Support	Not Support
ISUP	Support	Not Support
Hik-Connect	Support	Not Support
Picture server	Support	Only support local server work as picture server, Not Support storage、KMS
Live view (RTSP)	Support	Support
NTP	Support	Support
DHCP(V6)	Support	Support
WIFI	Support	Support
DNS	Support	Support

22. Function

- a. Support face mask recognition.
- b. Video intercom with indoor station, master station and platform;
- c. Multiple verification modes: Face, card, fingerprint(-F only), PIN code;
- d. Face recognition distance ranges from 0.3 to 3 meters;
- e. Support check in/check out/break out/break in/overtime in/overtime out attendance status, and self-define status name;

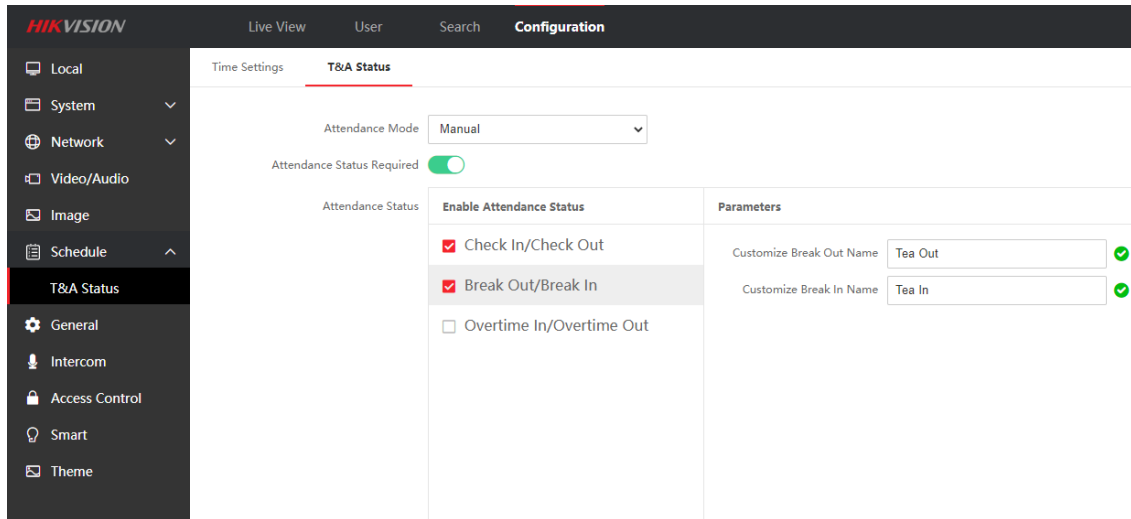

- f. Support privacy protection, customer can define the privacy related parameter, such as Event Storage Settings, Picture Uploading and Storage, Clear All Pictures in Device

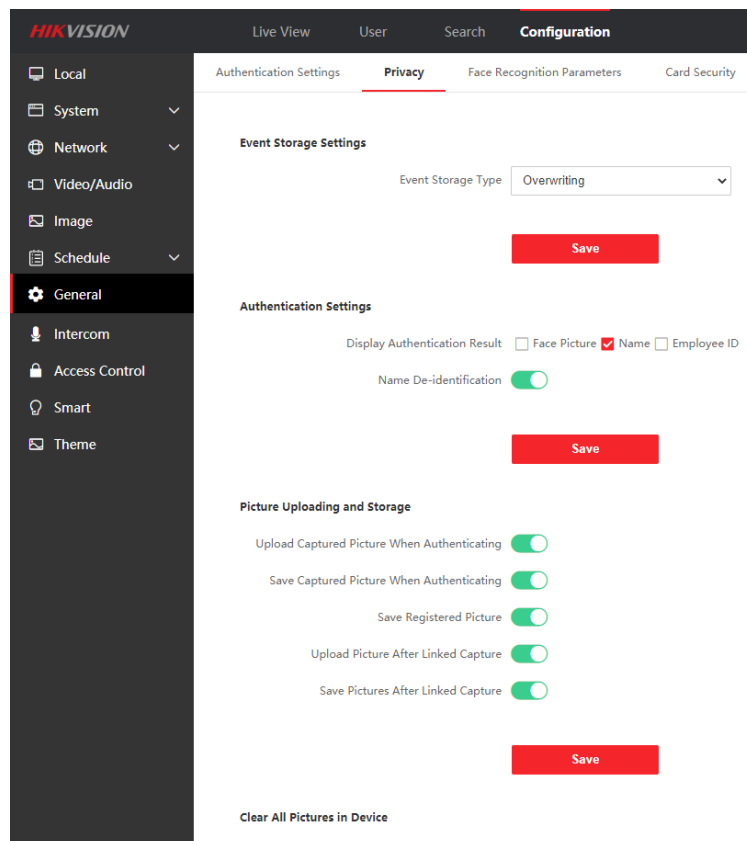

Customer Impact and Recommended Action

This update refers to function/compatibility improvement and will take effect automatically after the Date of Change. We are very sorry for any inconvenience of use-habit changes caused by this action. For any questions and request for this firmware, please contact our local technical support team.

Note:

- Hikvision reserves the right to change, alter or withdraw the above notification without prior notice.
- Product design and specifications are subject to change without prior notice.
- The Hikvision firmware may contain errors known as errata, which may cause the product to deviate from published specifications. Current characterized errata are available on request.
- Hikvision is not liable for any typing or printing errors.

Hikvision Digital Technology CO., Ltd.
No. 555 Qianmo Road, Binjiang District, Hangzhou 310051,
China
Tel: +86-571-8807-5998
FAX: +86-571-8993-5635
Email: overseabusiness@hikvision.com