

DS-K1T680 Series MinMoe Terminal Release Note (2022-09-30)

Device Model: DS-K1T680D(F)-E1 DS-K1T680D(F)W DS-K1T680D(F)G DS-K1T680D(F)G1 Naming Rule: D for M1 card, Desfire card, Felica card E1 for POE, W for Wi-Fi, F for fingerprint G1 for 3/4G, supported in Australia, Taiwan (China) and Latin America; G for 3/4G, supported in Europe, the Middle East, Africa, India, and Most Areas of Asia-Pacific (excluding Japan and Taiwan (China))	Firmware Version	ARM : ACS_680_AI3_EN_**STD**_V3.2.35_build2 20913 ACS_680_AI3_EN_**NEU**_V3.2.35_build2 20913
	Software Version	HikCentral AC: https://www.hikvision.com/en/support/download/software/hikcentral-access-control-v1-3-0/ iVMS: https://www.hikvision.com/en/support/download/software/ivms4200-series/

Reason of Upgrade

Fix bugs, enhance products quality and meet customers' requirements.

Modified Features

1. Optimize the face anti-spoofing algorithm

DS-K1T680 Series MinMoe Terminal Release Note (2022-07-10)

Device Model: DS-K1T680D(F)-E1 DS-K1T680D(F)W DS-K1T680D(F)G DS-K1T680D(F)G1 Naming Rule:	Firmware Version	ARM : ACS_680_AI3_EN_**STD**_V3.2.35_build2 20610 ACS_680_AI3_EN_**NEU**_V3.2.35_build2 20610
	Software Version	

D for M1 card, Desfire card, Felica card E1 for POE, W for Wi-Fi, F for fingerprint G1 for 3/4G, supported in Australia, Taiwan (China) and Latin America; G for 3/4G, supported in Europe, the Middle East, Africa, India, and Most Areas of Asia-Pacific (excluding Japan and Taiwan (China))	SDK	Latest version
	iVMS-4200 Version	Latest version

Reason of Upgrade

Fix bugs, enhance products quality and meet customers' requirements.

Modified Features

2. Fix the problem that the occasional face recognition frame is stuck
3. Fixed some ISAPI protocol integration issues

DS-K1T680 Series MinMoe Terminal Release Note (2022-04-09)

Device Model: DS-K1T680D(F)-E1 DS-K1T680D(F)W DS-K1T680D(F)G DS-K1T680D(F)G1 Naming Rule: D for M1 card, Desfire card, Felica card E1 for POE, W for Wi-Fi, F for fingerprint G1 for 3/4G, supported in Australia, Taiwan (China) and Latin America; G for 3/4G, supported in Europe, the Middle East, Africa, India, and Most Areas of Asia-Pacific (excluding Japan and Taiwan (China))	Firmware Version	ARM : ACS_680_AI3_EN_STD_V3.2.35_build2 20315 ACS_680_AI3_EN_NEU_V3.2.35_build2 20315
	SDK	Latest version
	iVMS-4200 Version	Latest version

Reason of Upgrade

Fix bugs, enhance products quality and meet customers' requirements.

Modified Features

4. Optimize the fingerprint module performance.

DS-K1T680 Series MinMoe Terminal Release Note (2022-03-09)

Device Model: DS-K1T680D(F)-E1 DS-K1T680D(F)W DS-K1T680D(F)G DS-K1T680D(F)G1 Naming Rule: D for M1 card, Desfire card, Felica card E1 for POE, W for Wi-Fi, F for fingerprint G1 for 3/4G, supported in Australia, Taiwan (China) and Latin America; G for 3/4G, supported in Europe, the Middle East, Africa, India, and Most Areas of Asia-Pacific (excluding Japan and Taiwan (China))	Firmware Version	ARM : ACS_680_AI3_EN_STD_V3.2.35_build2 20214 ACS_680_AI3_EN_NEU_V3.2.35_build2 20214
	SDK	Latest version
	iVMS-4200 Version	Latest version

Reason of Upgrade

Fix bugs, enhance products quality and meet customers' requirements.

Modified Features

5. Fix the problem that the occasional screen backlight cannot be turned off;
6. Fix the problem that the voice of the main station (DS-KM9503) could not be heard when talking with the main station.

DS-K1T680 Series MinMoe Terminal Release Note (2022-01-26)

Device Model: DS-K1T680D(F)-E1 DS-K1T680D(F)W DS-K1T680D(F)G DS-K1T680D(F)G1 Naming Rule: D for M1 card, Desfire card, Felica card E1 for POE, W for Wi-Fi, F for fingerprint G1 for 3/4G, supported in Australia, Taiwan (China) and Latin America; G for 3/4G, supported in Europe, the Middle East, Africa, India, and Most Areas of Asia-Pacific (excluding Japan and Taiwan (China))	Firmware Version	ARM : ACS_680_AI3_EN_STD_V3.2.35_build2 20114 ACS_680_AI3_EN_NEU_V3.2.35_build2 20114
	SDK	Latest version
	iVMS-4200 Version	Latest version

Reason of Upgrade

Add new function, fix bugs, enhance products quality and meet customers' requirements.

Modified Features

- Support **advertisement mode**: upload pictures from web and always display on the screen, recommend using company logo or advertisement picture.

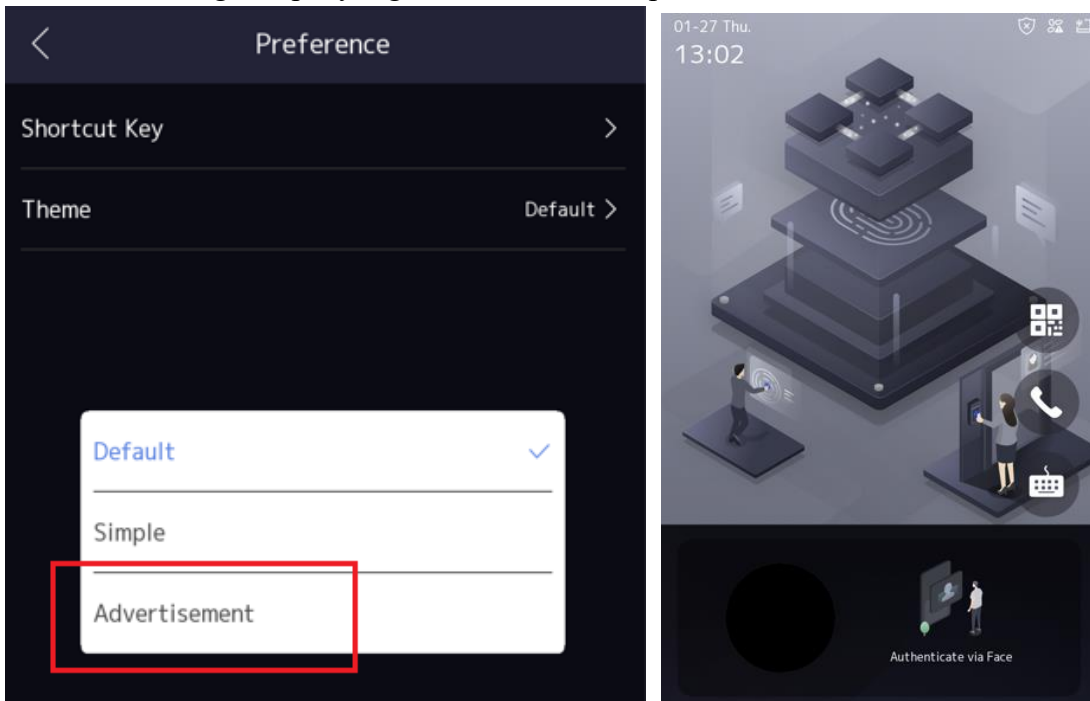

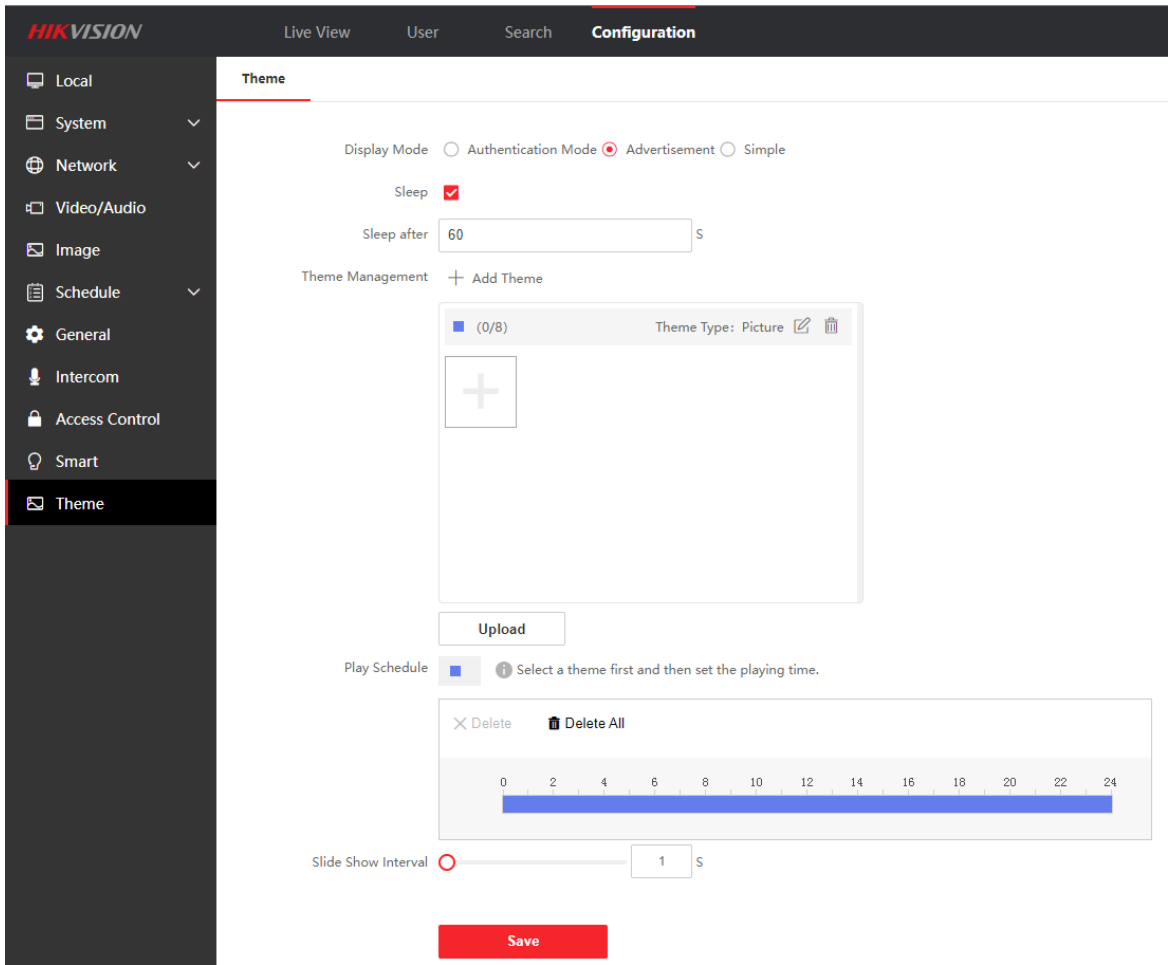

8. Support beauty function

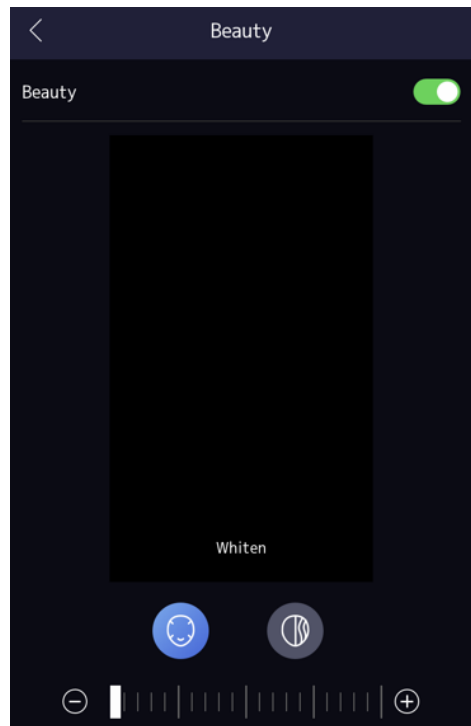
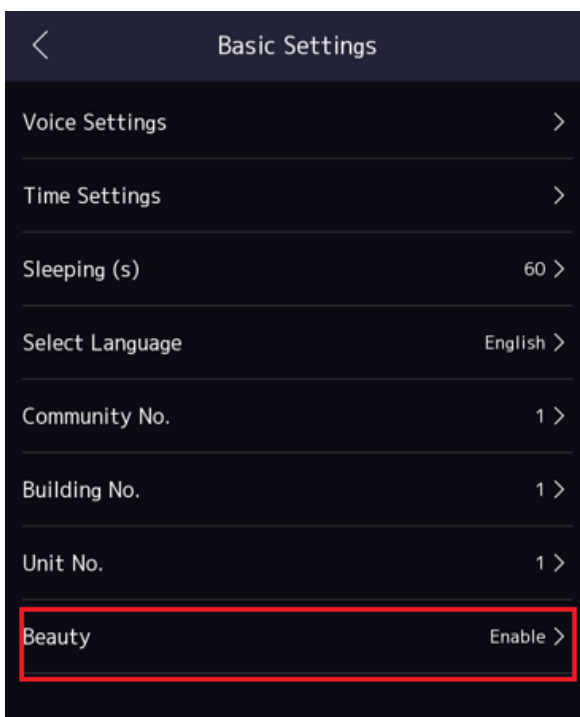

9. Support reset activation password with Hik-Connect APP and security email address.

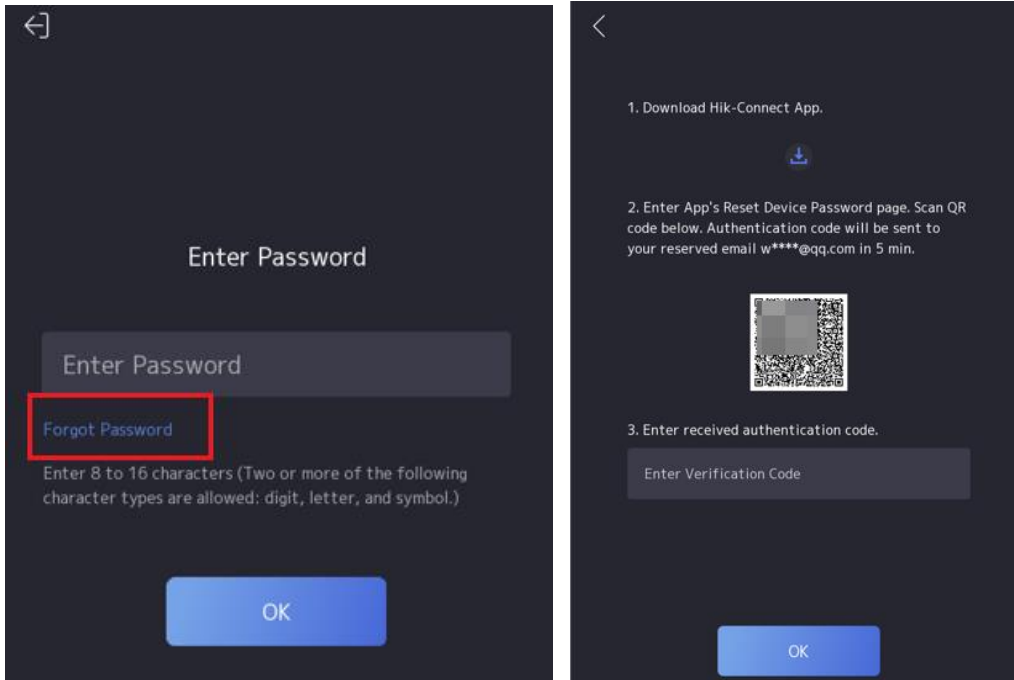

10. Support APN configuration.

Note: The parameter only work for model DS-K1T680D(F)G and DS-K1T680D(F)G1

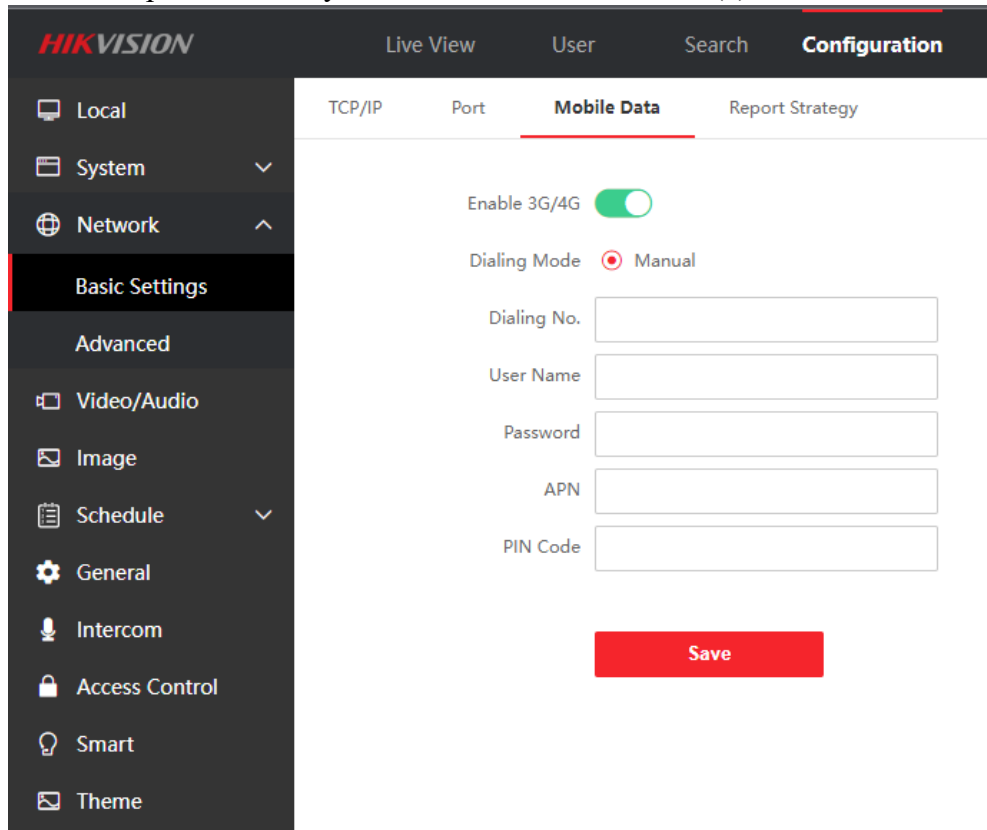

DS-K1T680 Series MinMoe Terminal Release Note (2022-01-04)

Device Model: DS-K1T680D(F)-E1 DS-K1T680D(F)W DS-K1T680D(F)G DS-K1T680D(F)G1 Naming Rule: D for M1 card, Desfire card, Felica card E1 for POE, W for Wi-Fi, F for fingerprint G1 for 3/4G, supported in Australia, Taiwan (China) and Latin America; G for 3/4G, supported in Europe, the Middle East, Africa, India, and Most Areas of Asia-Pacific (excluding Japan and Taiwan (China))	Firmware Version	ARM : ACS_680_AI3_EN_STD_V3.2.33_build211223 ACS_680_AI3_EN_NEU_V3.2.33_build211223
	SDK	Latest version
	iVMS-4200 Version	Latest version

Reason of Upgrade

Add new function, fix bugs, enhance products quality and meet customers' requirements.

Modified Features

11. Update the driver to be compatible with the new fingerprint module;
12. Optimize the platform data synchronization logic;
13. Fixed break out/in opposite status issue.

DS-K1T680 Series MinMoe Terminal Release Note (2021-12-10)

Device Model: DS-K1T680D(F)-E1 DS-K1T680D(F)W DS-K1T680D(F)G DS-K1T680D(F)G1 Naming Rule: D for M1 card, Desfire card, Felica card E1 for POE, W for Wi-Fi, F for fingerprint G1 for 3/4G, supported in Australia, Taiwan (China) and Latin America; G for 3/4G, supported in Europe, the Middle East, Africa, India, and Most Areas of Asia-Pacific (excluding Japan and Taiwan (China))	Firmware Version	ARM : ACS_680_AI3_EN_STD_V3.2.33_build 211122 ACS_680_AI3_EN_NEU_V3.2.33_buil d211122
	SDK	Latest version
	iVMS-4200 Version	Latest version

Reason of Upgrade

Add new function, fix bugs, enhance products quality and meet customers' requirements.

Modified Features

1. Compatible with new fingerprint module
2. Optimize ISAPI protocol related functions

DS-K1T680 Series MinMoe Terminal Release Note (2021-11-18)

Device Model: DS-K1T680D(F)-E1 DS-K1T680D(F)W DS-K1T680D(F)G DS-K1T680D(F)G1 Naming Rule:	Firmware Version	ARM : ACS_680_AI3_EN_STD_V3.2.33_build 211116 ACS_680_AI3_EN_NEU_V3.2.33_buil d211116

D for M1 card, Desfire card, Felica card E1 for POE, W for Wi-Fi, F for fingerprint G1 for 3/4G, supported in Australia, Taiwan (China) and Latin America; G for 3/4G, supported in Europe, the Middle East, Africa, India, and Most Areas of Asia-Pacific (excluding Japan and Taiwan (China))	SDK	Latest version
	iVMS-4200 Version	Latest version

Reason of Upgrade

Add new function, fix bugs, enhance products quality and meet customers' requirements.

Modified Features

1. Fix the device offline issue caused by searching device event from iVMS4200 client through ISUP5.0 protocol;
2. Fixed some issues about ISAPI protocol.
3. Optimize the connection with HikCentral Professional platform;

DS-K1T680 Series MinMoe Terminal Release Note (2021-10-18)

Device Model: DS-K1T680D(F)-E1 DS-K1T680D(F)W DS-K1T680D(F)G DS-K1T680D(F)G1 Naming Rule: D for M1 card, Desfire card, Felica card E1 for POE, W for Wi-Fi, F for fingerprint G1 for 3/4G, supported in Australia, Taiwan (China) and Latin America;	Firmware Version	ARM : ACS_680_AI3_EN_STD_V3.2.33_build 210731 ACS_680_AI3_EN_NEU_V3.2.33_buil d210731
	SDK	Latest version

G for 3/4G, supported in Europe, the Middle East, Africa, India, and Most Areas of Asia-Pacific (excluding Japan and Taiwan (China))	iVMS-4200 Version	Latest version
--------------------------------------------------------------------------------------------------------------------------------------	----------------------	----------------

Add new function, fix bugs, enhance products quality and meet customers' requirements.

New Features

1. Add Hik-Connect menu in device UI Menu → Comm. The function is disabled in default.

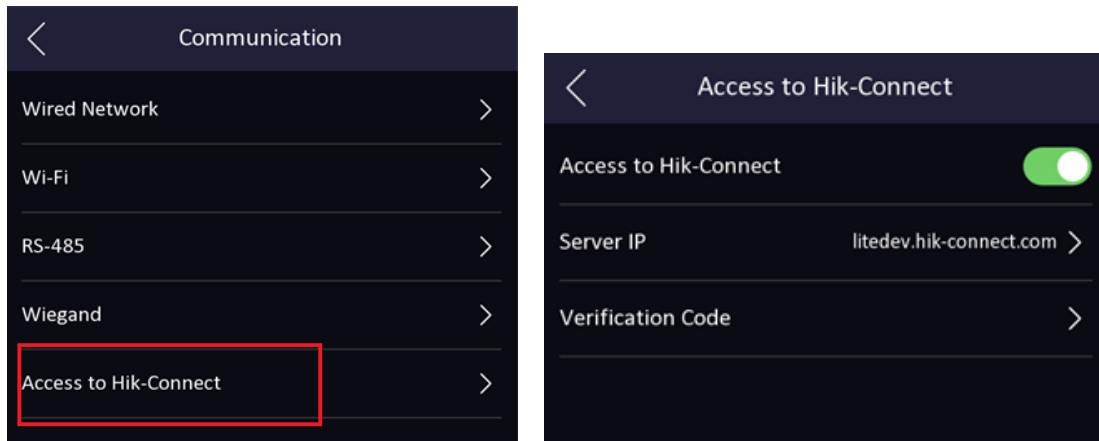

Modified Features

1. Optimize the wake-up distance of the device screen through the face, and the wake-up distance is consistent with the recognition distance

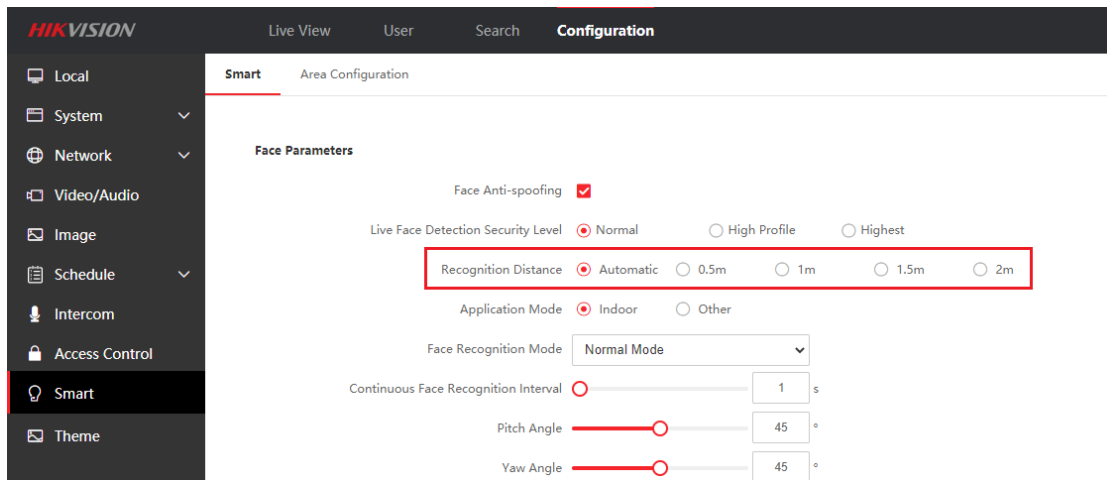

DS-K1T680 Series MinMoe Terminal Release Note (2021-06-28)

Device Model: DS-K1T680D(F)-E1 DS-K1T680D(F)W DS-K1T680D(F)G DS-K1T680D(F)G1 Naming Rule: D for M1 card, Desfire card, Felica card E1 for POE W for Wi-Fi F for fingerprint G1 for 3/4G, supported in Australia, Taiwan (China) and Latin America; G for 3/4G, supported in Europe, the Middle East, Africa, India, and Most Areas of Asia-Pacific (excluding Japan and Taiwan (China))	Firmware Version	ARM : ACS_680_AI3_EN_STD_V3.2.33_build210610 ACS_680_AI3_EN_NEU_V3.2.33_build210610
	SDK	Latest version
	iVMS-4200 Version	Latest version

Reason of Upgrade

Fix bugs, enhance products quality and meet customers' requirements.

Modified Features

2. Optimize the function of exporting data to U disk.
3. Optimize the working mechanism of infrared fill light

DS-K1T680 Series MinMoe Terminal Release Note (2021-03-23)

Device Model: DS-K1T680D(F)-E1 DS-K1T680D(F)W DS-K1T680D(F)G DS-K1T680D(F)G1 Naming Rule: D for M1 card, Desfire card, Felica card E1 for POE W for Wi-Fi F for fingerprint	Firmware Version	ARM : ACS_680_AI3_EN_STD_V3.2.3_build210303 ACS_680_AI3_EN_NEU_V3.2.3_build210303
	SDK	HCNetSDKV6.1.5.15_build20200713_win32_EN

<p>G1 for 3/4G, supported in Australia, Taiwan (China) and Latin America;</p> <p>G for 3/4G, supported in Europe, the Middle East, Africa, India, and Most Areas of Asia-Pacific (excluding Japan and Taiwan (China))</p>	<p>iVMS-4200 Version</p>	<p>Latest version</p>
-----------------------------------------------------------------------------------------------------------------------------------------------------------------------------------------------------------------------------------------	------------------------------	-----------------------

Reason of Upgrade

Add new features, fix bugs, enhance products quality and meet customers' requirements.

New Feature

1. Support https feature

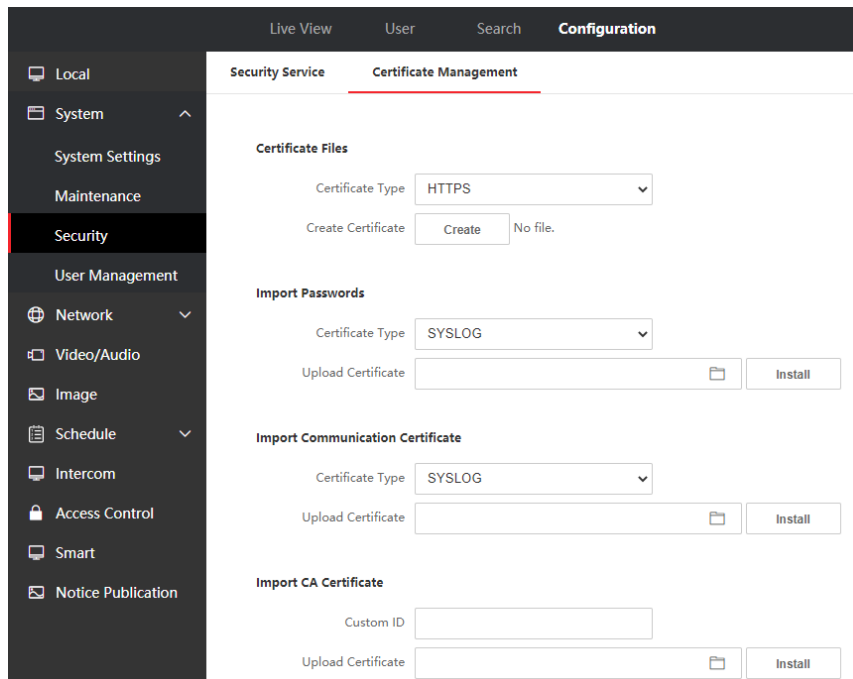

2. Support Hik-ProConnect platform docking

3. Add beauty function to adjust smooth and whiten parameter.

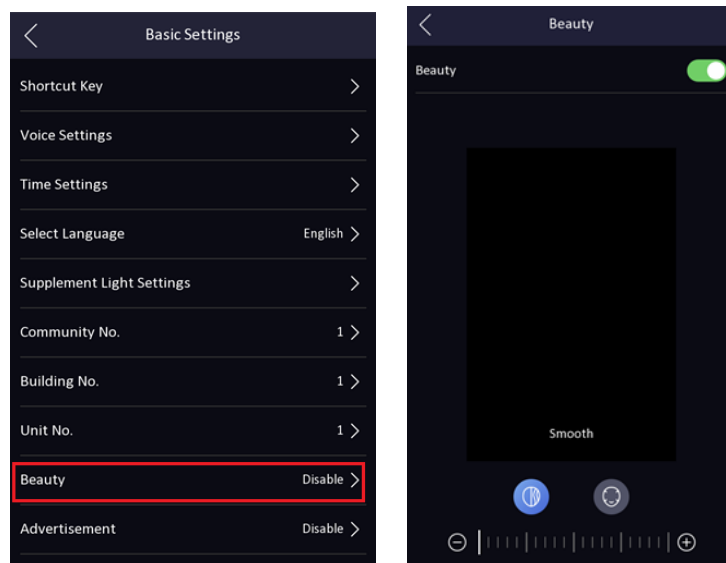

4. Add device operation log query function in web interface (login device in browser), we can check the device operation log from here.

For access control authentication log, please turn to **Search** module.

No.	Time	Major Type	Minor Type	Channel No.	Local/Remote User	Remote Host IP
01	2021-01-25 14:05:53+08:00	Operation	Remote: Restore to Default Set...	-	WEB	10.9.96.43
02	2021-01-25 14:09:37+08:00	Operation	Local: Delete Face Picture Data	-	UI	local
03	2021-01-25 14:09:51+08:00	Information	Add Person Information	-	UI	local
04	2021-01-25 14:09:51+08:00	Information	Add Card	-	UI	local
05	2021-01-25 14:09:51+08:00	Operation	Local: Face Picture Data Entry	-	UI	local
06	2021-01-25 14:09:51+08:00	Information	Add Fingerprint (By Employee I...	-	UI	local
07	2021-01-25 14:09:58+08:00	Operation	Enter Home Page	-	UI	local
08	2021-01-25 14:10:07+08:00	Operation	Enter Home Page	-	UI	local
09	2021-01-25 14:12:20+08:00	Operation	Enter Home Page	-	UI	local
10	2021-01-25 14:29:51+08:00	Operation	Enter Home Page	-	UI	local

5. Add ISAPI event monitoring upload (HTTP listening) function

No.	Destination IP or Host Name	URL	Port	Protocol
1	0.0.0.0	/	80	HTTP
2	0.0.0.0	/	80	HTTP

6. Support unbind device with hik-connect account on SADP tool, local UI and web

Total number of online devices: **67**

ID	Device Type	Status	IPv4 Address	Port	Enhanced SDK Service Port	Software Version	IPv4 Gateway	HTTP Port	Device Serial No.
064	DS-K1T671MF	Active	10.9.96.50	8000	N/A	V3.2.0build 2101...	10.9.96.254	80	DS-K1T671MF20210107V0302

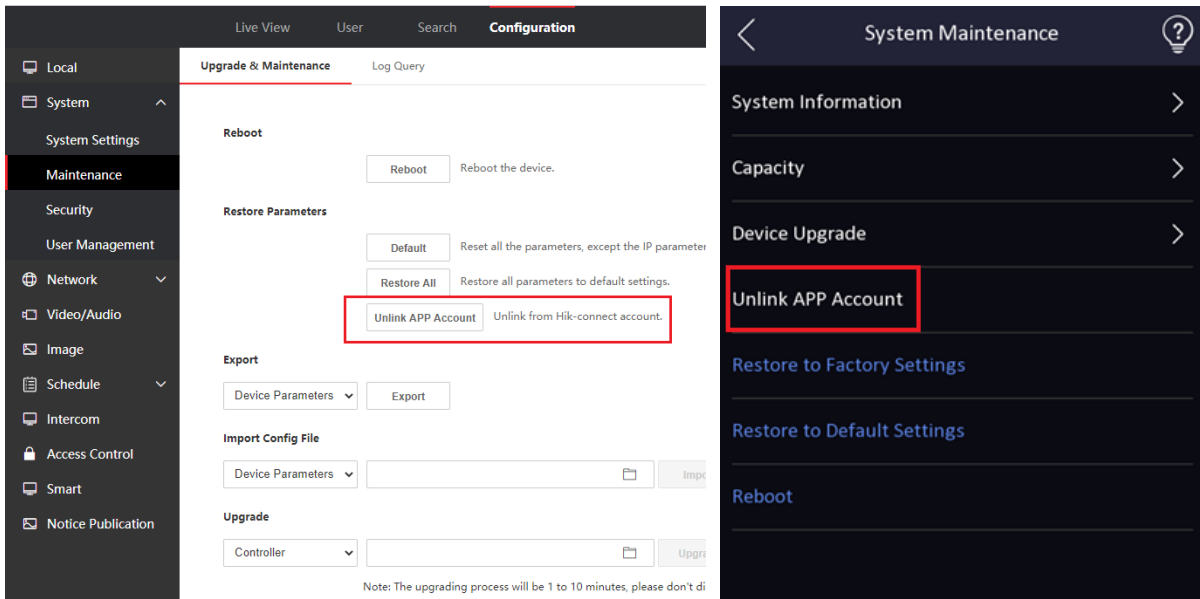

7. Add privacy protection, support event Storage Settings, Picture Uploading and Storage, Clear All Pictures in Device

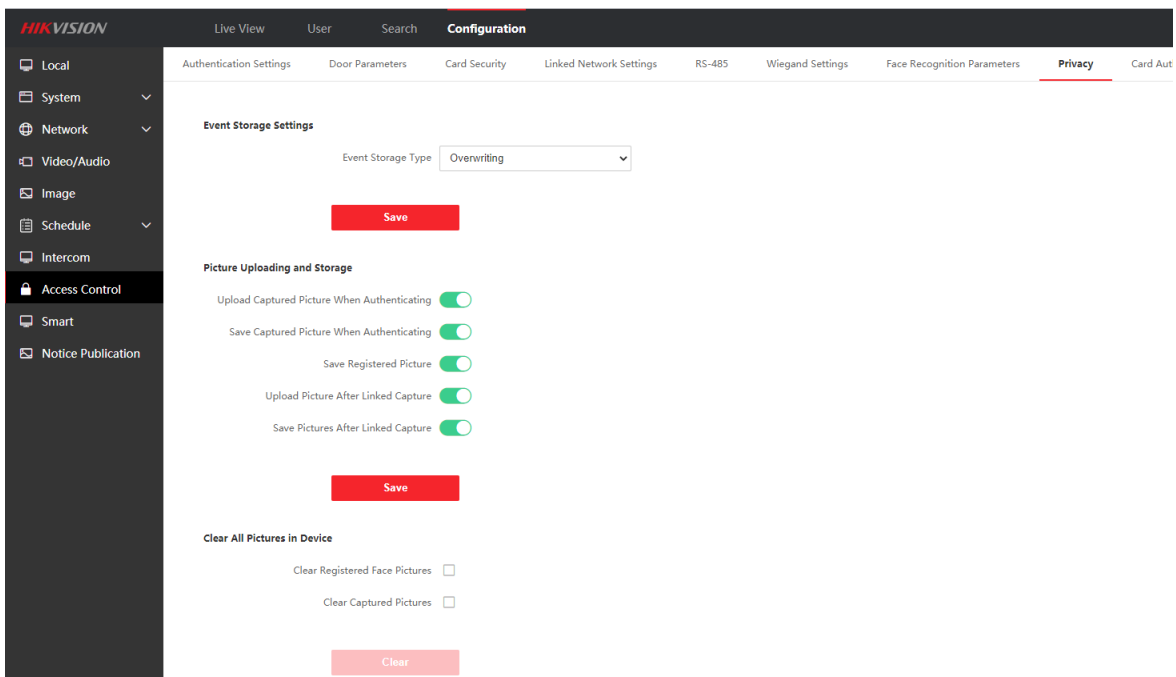

8. Add face mask detection function(enabled in default);

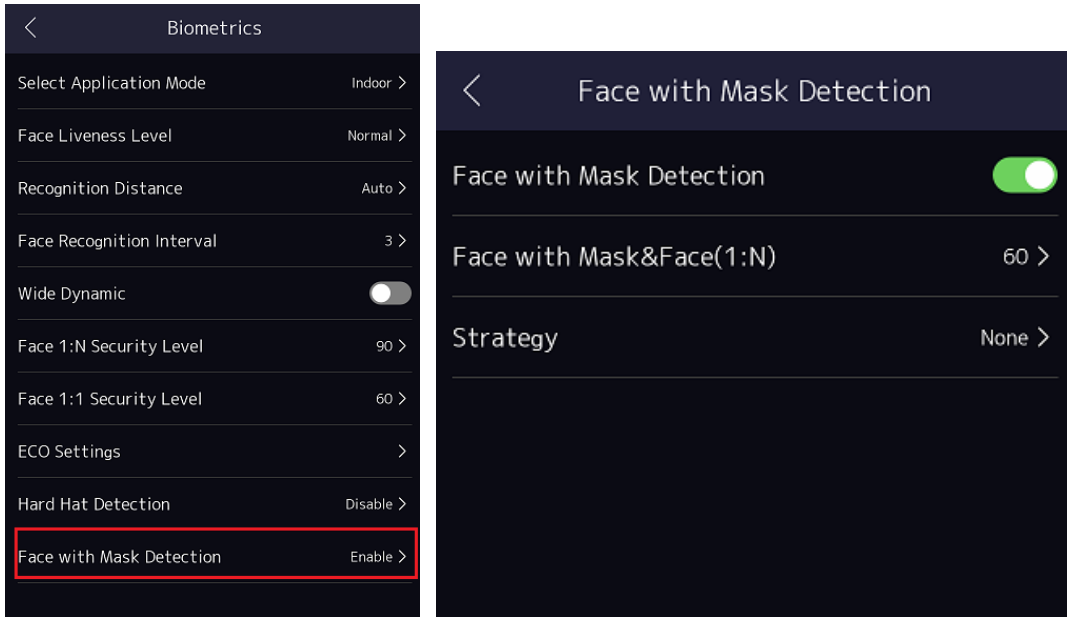

9. Add help interface to check system module version for technical support (long press for 3s).

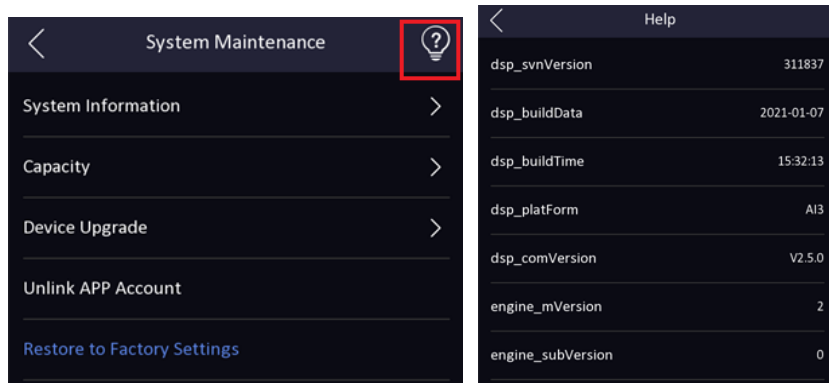

10. Add card No. reversing function (external reader not support)

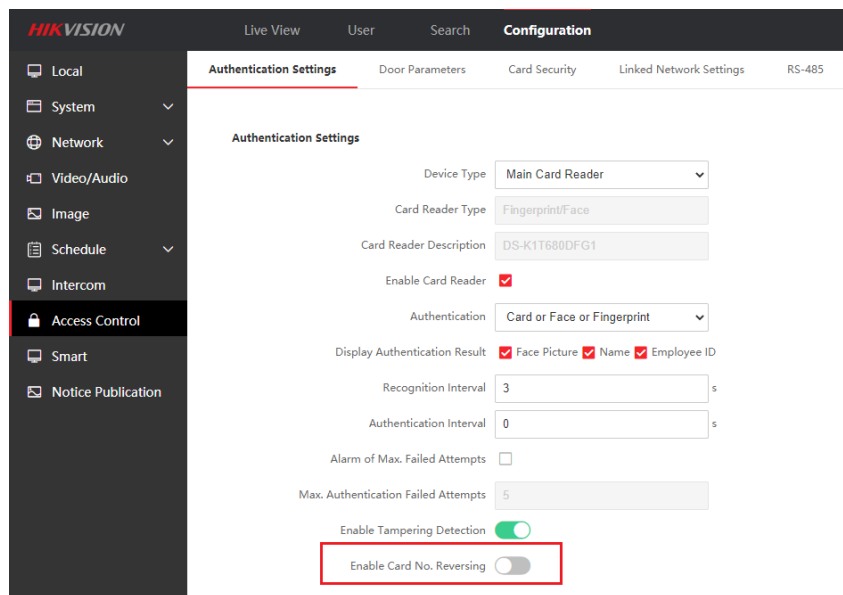

Modified Features

- Hik-Connect function is turned off in default for privacy protection, if customer want to manage device from App, please turn on manually in the web.

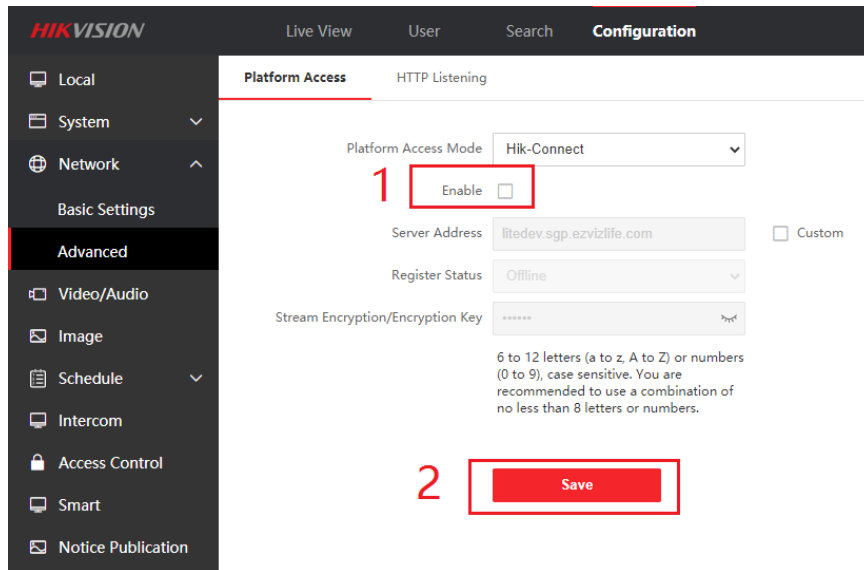

- DNS can be configured from device UI in menu → Comm.-->Wired Network

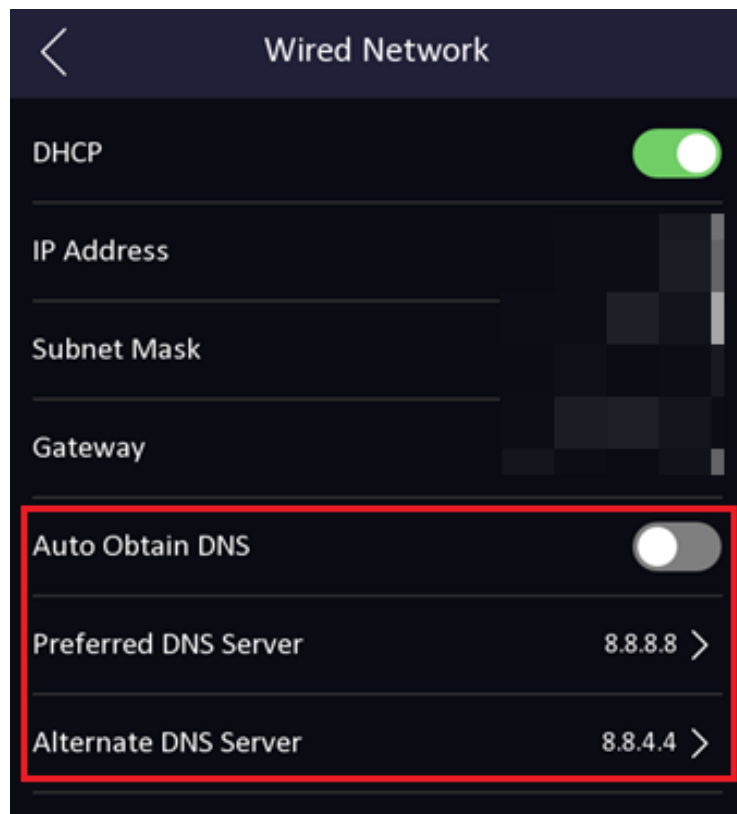

- After disable QR code shortcut from the menu, device will support QR code and face verification at the same time.

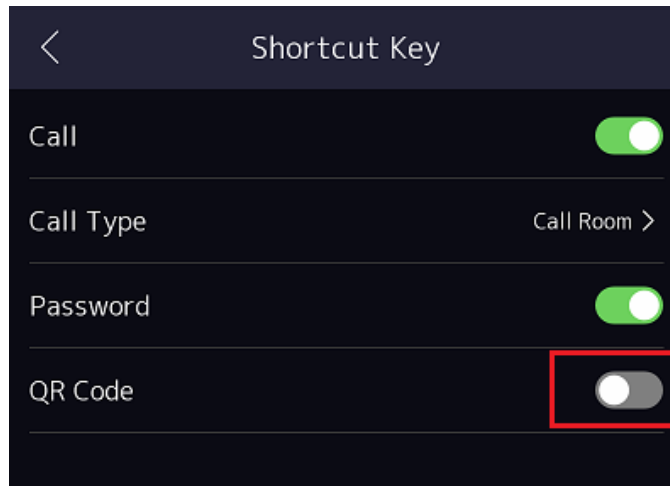

7. Optimized the ISUP and Hik-Connect event upload mechanism.
8. When verify with unregistered person face picture, device will not give any prompt.
9. When verify with registered person face picture, screen will show “Please adjust position” and will not play audio
10. Add stranger authentication timeout interval configuration.

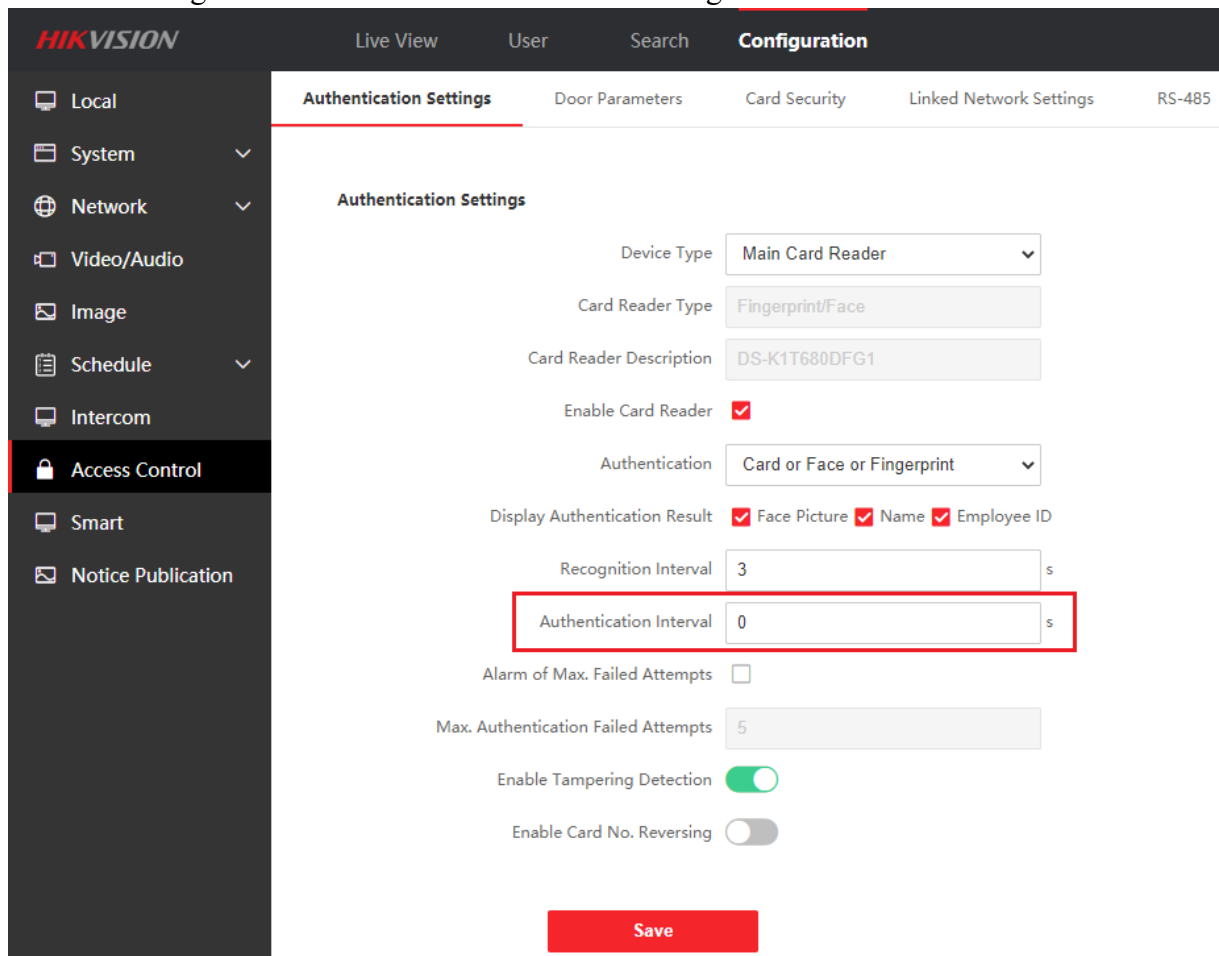

Customer Impact and Recommended Action

This update refers to function/compatibility improvement and will take effect automatically after the Date of Change. We are very sorry for any inconvenience of use-habit changes caused by this action. For any questions and request for this firmware, please contact our local technical support team.

Note:

- Hikvision reserves the right to change, alter or withdraw the above notification without prior notice.
- Product design and specifications are subject to change without prior notice.
- The Hikvision firmware may contain errors known as errata, which may cause the product to deviate from published specifications. Current characterized errata are available on request.
- Hikvision is not liable for any typing or printing errors.

Hikvision Digital Technology CO., Ltd.
No. 555 Qianmo Road, Binjiang District, Hangzhou 310051,
China
Tel: +86-571-8807-5998
FAX: +86-571-8993-5635
Email: overseabusiness@hikvision.com