

AX PRO
Version: V1.2.1
Release Note
(2020-10-13)

1. Firmware Basic Information

Firmware Basic Information	Firmware Version	V1.2.1_build200918
	Web Version	V4.25.1 build 200918

2. V1.2.1 Upgrade Note

2.1 Added Function:

1) Support new wireless Peripherals:

Relay Module DS-PM1-O1L-WE(B)、 Wall Switch DS-PM1-O1H-WE(B), Smart Plug DS-PSP1-WE(B) , RF Repeater DS-PR1-WE(B) , ColorVu PIR Camera DS-PDPC12PF-EG2-WE(B)

2) Added local user Function :

- 1) Local User configuration : support configure Keypad password, Duress Code, link to Keyfob and Tag.

The screenshot shows the 'Add User' form with the following fields and values:

- User Type: Operator
- User Name: operator test 1
- Disposable User:
- Keypad Password: [Redacted] ✓
- Duress Code: [Redacted] ✓
- Keyfob: [Empty]
- Tag: [Empty]
- Area: Active Functions, Area1, Area2

A red box highlights the 'Keypad Password', 'Duress Code', 'Keyfob', and 'Tag' fields.

- 2) **Support Disposable User**, Keypad password can arm and disarm one time(The password is valid for 24 hours)

The screenshot shows the 'Add User' form with the following fields and values:

- User Type: Operator
- User Name: [Empty]
- Disposable User: (Red box highlights this toggle)
- Keypad Password: [Empty]
- Area: Active Functions, Area1, Area2, Area3
- User Permission: Select All, Arm Permission, Disarm Permission

A red box highlights the 'Disposable User' toggle.

3) Add New multiple languages

Support more multiple languages: **Czech, Dutch, Greek, Hungarian, Turkish, Croatian, Ukrainian**



4) Support Keypad manual control Automation Device

The keypad supports manual control of automation device functions;

Command: [Password code] +  + [Automation number] + #

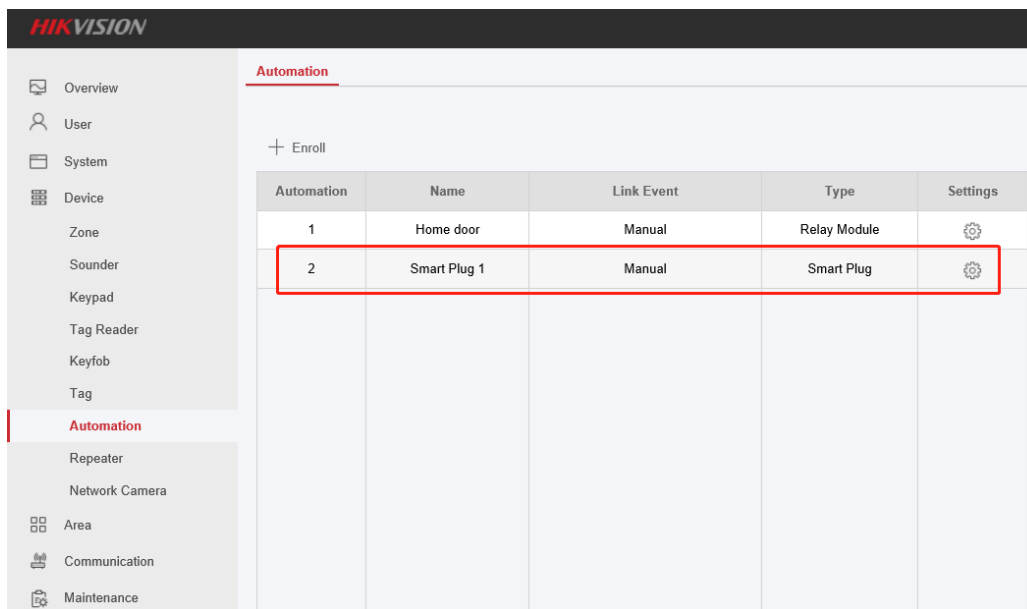
For Example : 1234+  + 2 + #



Automation	Name	Link Event	Type	Settings
1	Home door	Manual	Relay Module	
2	Smart Plug 1	Manual	Smart Plug	

5) Support Automation Configuration

Automation

No.

Name

Serial No.

Type

Linked Area

- Active Functions
- Area1
- Area2

Original Status

Polling Rate

Voltage Protection

Current Protection

Scenario Setting

Event Type	Parameter Setting
<input type="checkbox"/> Alarm	Activation Mode <input type="text" value="Pulse"/>
<input type="checkbox"/> Schedule	Pulse Duration <input type="text" value="5"/> s <small>Range 5-600 s</small>
<input type="checkbox"/> Arm	
<input type="checkbox"/> Disarm	
<input type="checkbox"/> Silence Alarm	
<input type="checkbox"/> Fault	
<input checked="" type="checkbox"/> Manual	

6) Support Keyfob manual control Automation Device

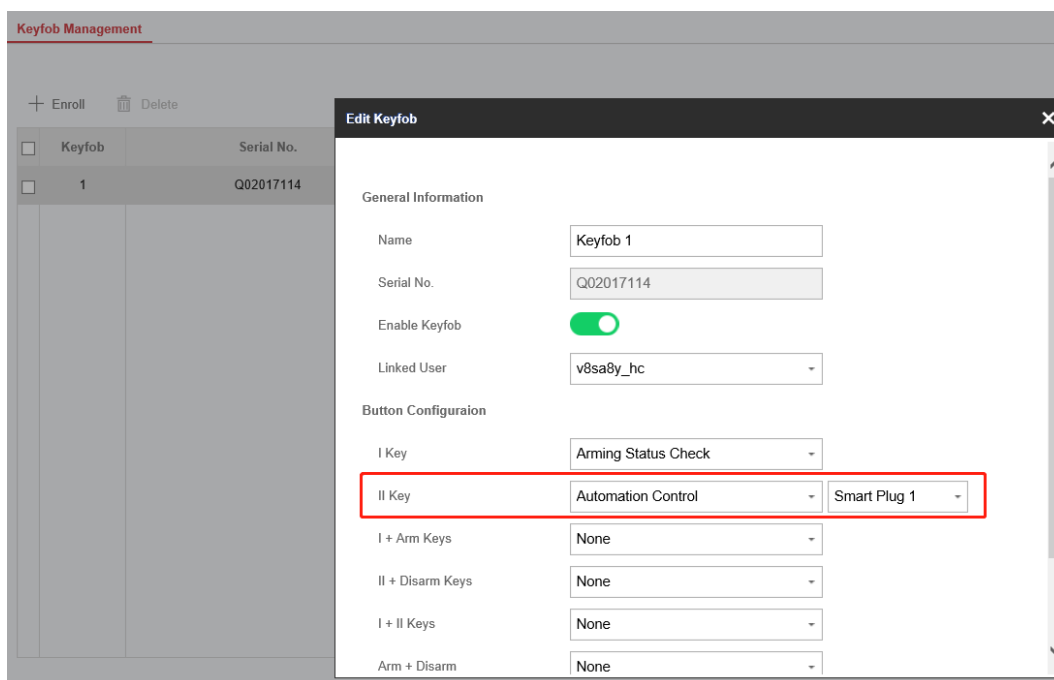

7) Support Emergency Button manual control Automation Device

Emergency button support 2 Mode : Work as Detector or Link to Automation Device, if select to Automation Control, can control Automation Device output manually

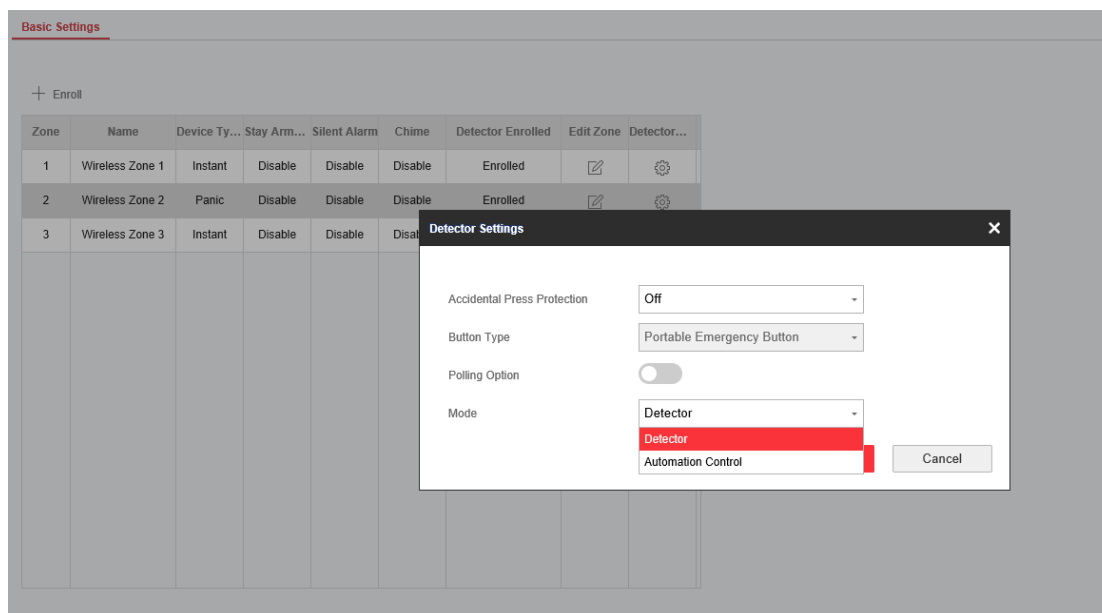

8) Add Tag Reader Configuration in Hik-connect

Hik-connect supports Tag times Auto-lock (maximum number of attempts) and Auto-lock time (wireless Tag reader lock time) configuration of the Tag reader, and supports unlocking operation.

9) Support Read Peripherals QSG Document in Hik-connect

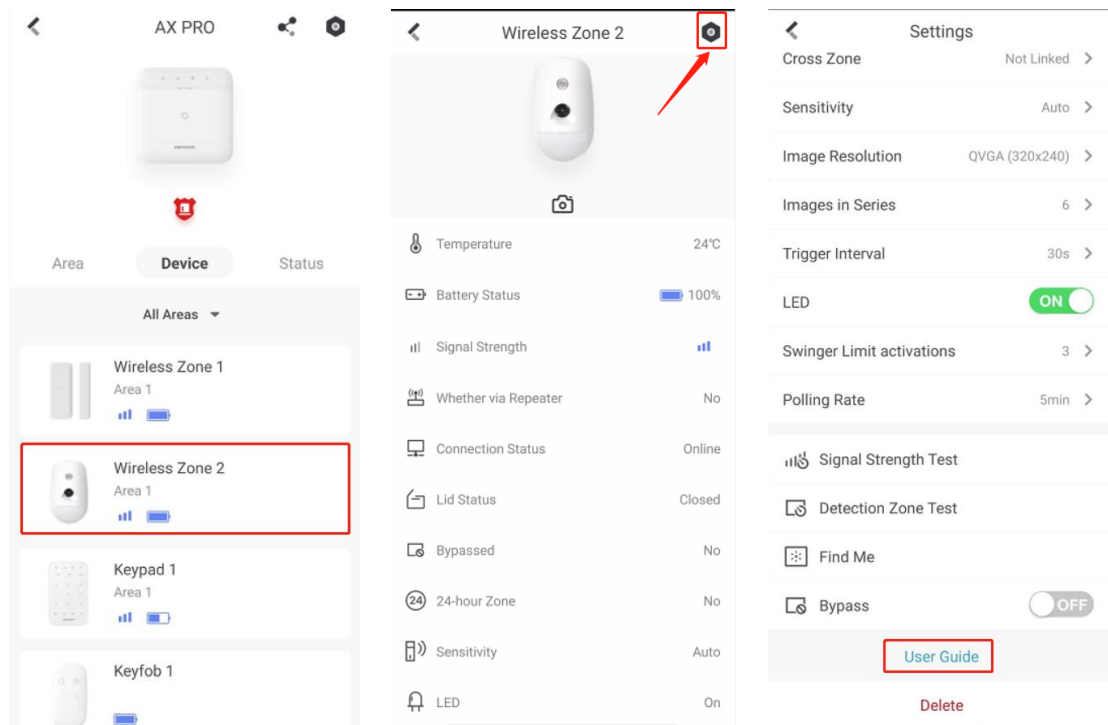

10) Support PIRCAM Detector Event picture or video be saved to mobile phone in Hik-connect

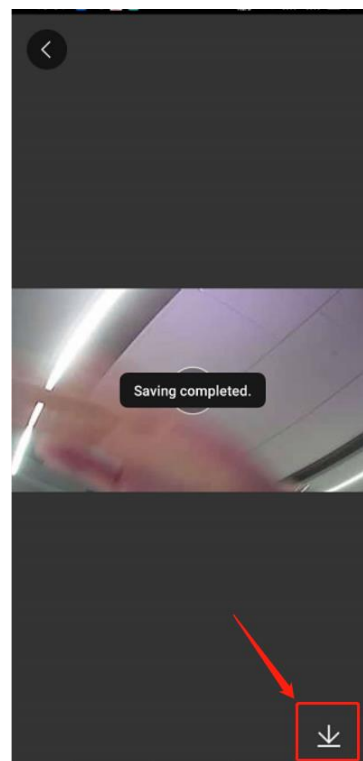
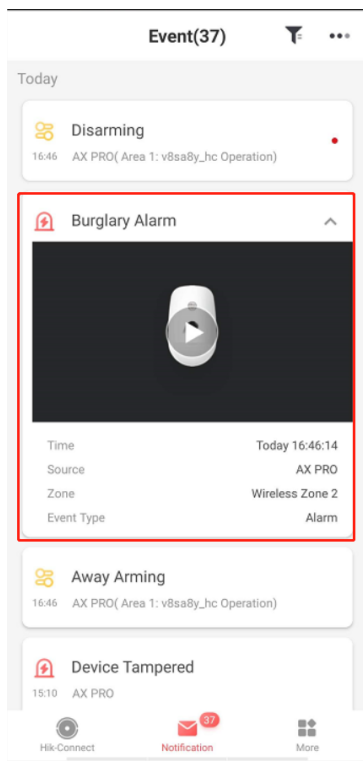

11) Support change Hik-connect User Alias and show User name in Event

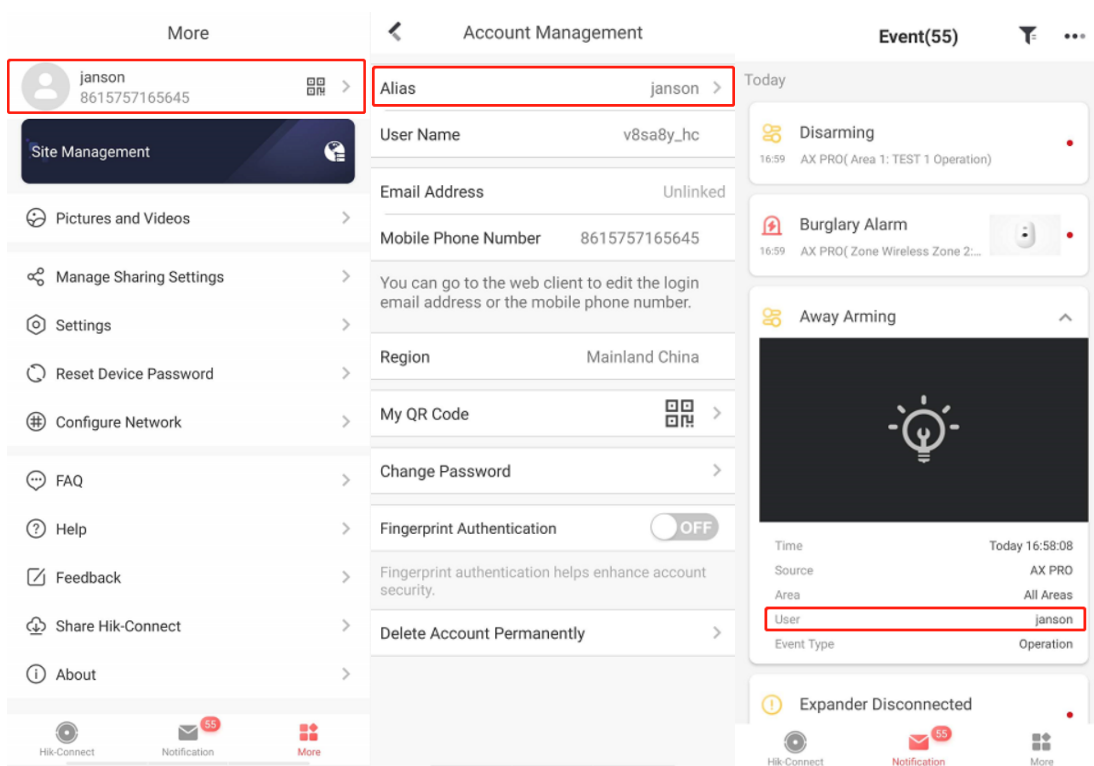

2. Feature Optimization:

1) Keypad, Tag Reader, Sounder Linked Area Optimization

When the keypad, Tag reader, and sounder configured, support show the linked Area.

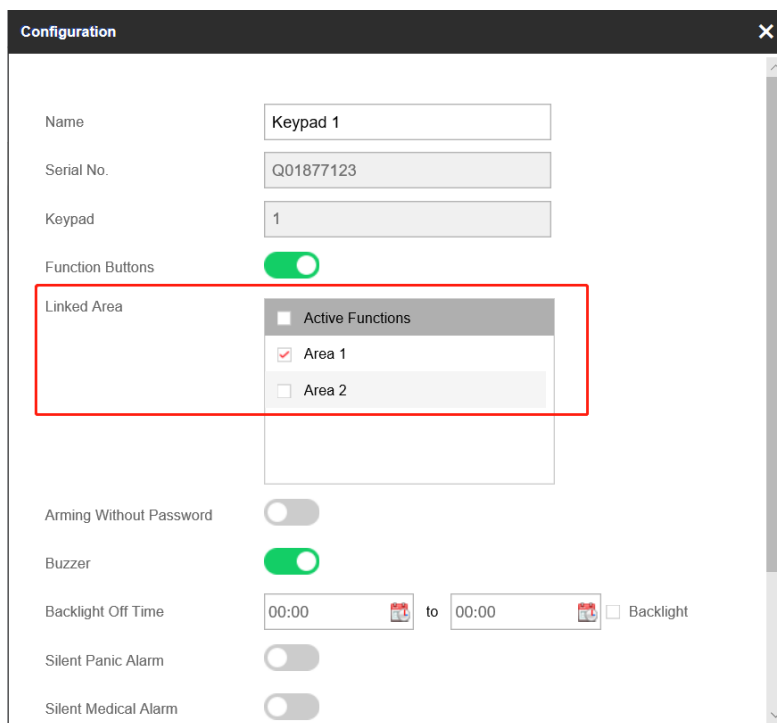

2) EN Standard Configuration Reminder Optimization

When modifying EN standard configuration items, it will show **The system will not be compliant with the Europe EN50131-1 standard after you disable this configuration option.**

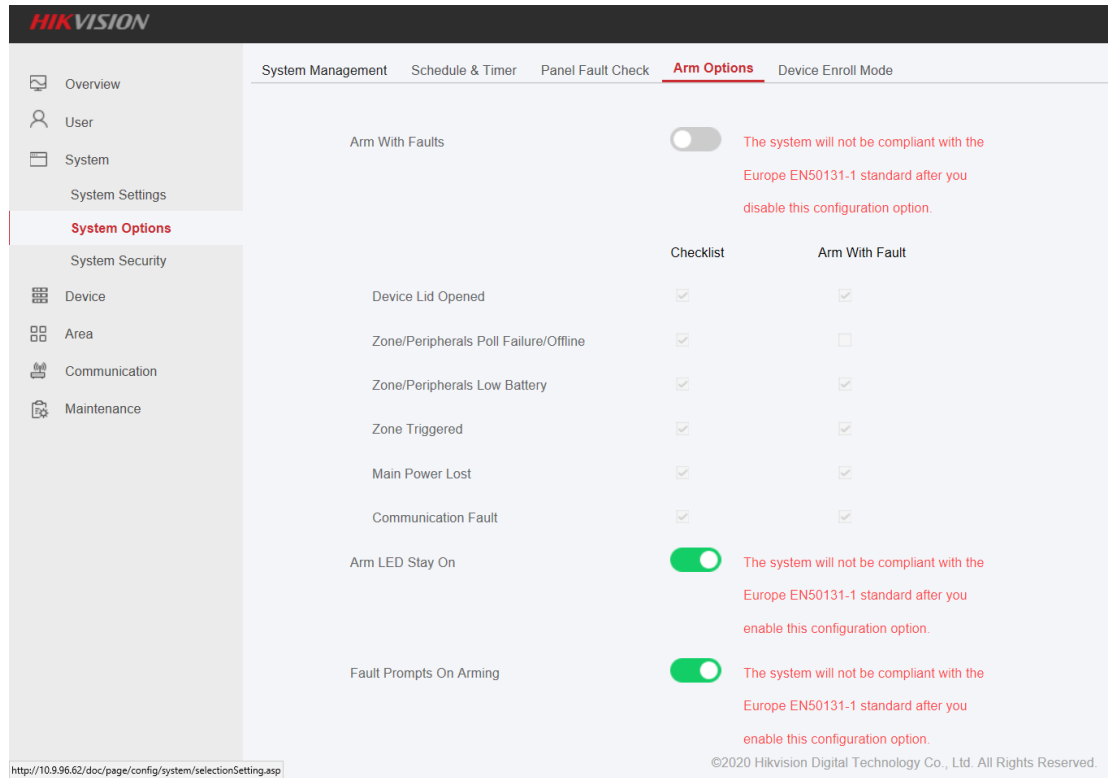

3) PIRCAM Detector Status Page Optimization

The PIRCAM Detector capture icon moves to the detector status page

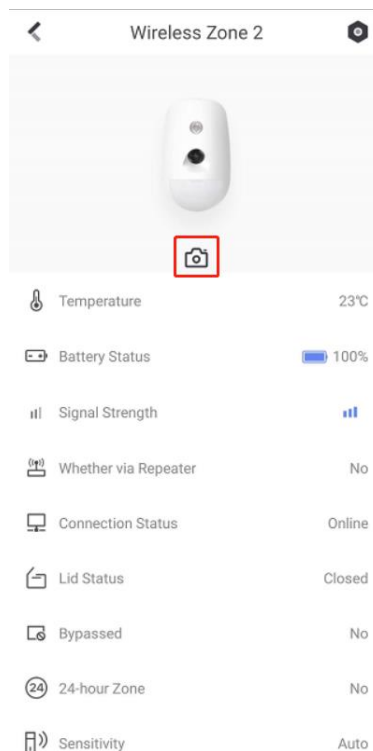

4) Hik-Connect Event Interface Optimization

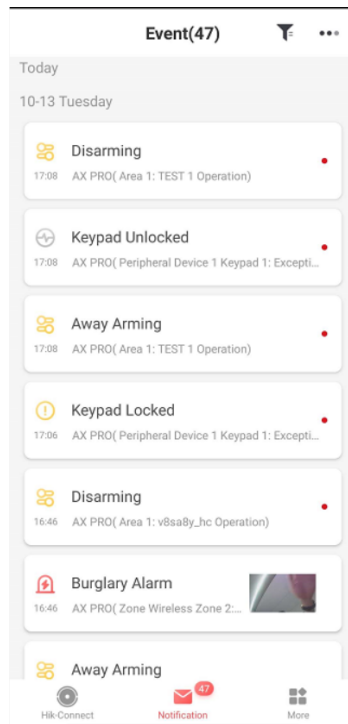

5) Hik-Connect interface refresh function Optimization to improve customer experience

6) Keyfob Status interface Optimization

Support show current functions of Linked User, I Key, II Key and other key combinations..

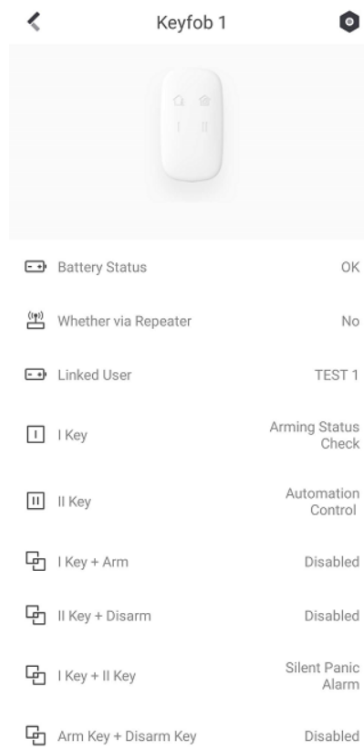

Remarks:

- Hikvision reserves the right to change, alter or withdraw the above notification without prior notice.
- Product design and specifications are subject to change without prior notice.
- The Hikvision firmware may contain errors known as errata which may cause the product to deviate from published specifications. Current characterized errata are available on request.
- Hikvision is not liable for any typing or printing errors.

Hikvision Digital Technology CO., Ltd.
No. 555 Qianmo Road, Binjiang District, Hangzhou 310051,
China
Tel: +86-571-8807-5998
FAX: +86-571-8993-5635
Email: overseabusiness@hikvision.com